

NOTICE!!

These documents have been scanned!

Do not place un-scanned documents beneath this notice!

Do not remove this notice from this file!

GPO Jacket No. 560-102
Print Order 61540
Rise Business Services, LLC
Job=AZ15 5/10/2019



Box Number= AZ15031



Claim Begin-End: AMC429963-AMC429963

1 Initial Receipt



AZ15031-24

AMC429540-AMC429995

United States Department of the Interior
Bureau of Land Management
 LANDS/RECREATION & PLANNING
 ONE N CENTRAL AVE
 PHOENIX, AZ 85004 -2203
 Phone: 602-417-9200

Receipt

No: 3170082

Transaction #: 3262851	
Date of Transaction: 11/17/2014	
CUSTOMER:	
PHILLIP L CONDREY PO BOX 684 HUMBOLDT, AZ 86329-0684 US	

LINE #	QTY	DESCRIPTION	REMARKS	UNIT PRICE	TOTAL
1	1.00	LOCATABLE MINERALS / MINING CLAIMS-NEW, UNADJUD, ONE OR MORE AUTH NOS / NEW MINING CLAIMS LOCATION FEE CASES: AMC429963/\$37.00		- n/a -	37.00
2	1.00	LOCATABLE MINERALS / MINING CLAIMS-NEW, UNADJUD, ONE OR MORE AUTH NOS / NEW MINING CLAIM PROCESSING FEE CASES: AMC429963/\$20.00		- n/a -	20.00
3	1.00	LOCATABLE MINERALS / MINING CLAIMS-NEW, UNADJUD, ONE OR MORE AUTH NOS / NEW MINING CLAIMS MAINTENANCE FEE CASES: AMC429963/\$155.00		- n/a -	155.00
4	1.00	LOCATABLE MINERALS / MINING CLAIMS-NOT NEW-UNADJUD, ONE AUTH NO. ONLY / MINING CLAIM MONEY RECEIVED CASES: AMC429963/\$155.00	NEW ASSOC PLACER LOCATION	- n/a -	155.00
TOTAL:					\$367.00

REFUND AUTHORIZED OVER PAYMENT pm 7/15/2015

PAYMENT INFORMATION			
1	AMOUNT:	367.00	POSTMARKED: N/A
	TYPE:	CHECK	RECEIVED: 11/17/2014
	CHECK NO:	1003	
	NAME:	SOLACIUM ENTERPRISES LLC 14005 E WAGONWHEEL DR	

DEWEY AZ 86327 US

REMARKS

This receipt was generated by the automated BLM Collections and Billing System and is a paper representation of a portion of the official electronic record contained therein.

NOTICE!!

These documents have been scanned!

Do not place un-scanned documents beneath this notice!

Do not remove this notice from this file!

GPO Jacket No. 560-102
Print Order 61540
Rise Business Services, LLC
Job=AZ15 5/10/2019



Box Number= AZ15031



Claim Begin-End: AMC429963-AMC429963

2 Correspondence



AZ15031-24

AMC429540-AMC429995



United States Department of the Interior



BUREAU OF LAND MANAGEMENT
Arizona State Office
One North Central Avenue, Suite 800
Phoenix, Arizona 85004-4427
www.blm.gov/az/

SEP 30 2020

In Reply Refer To:

3800 (9200) RM

AMC390560, AMC390605, AMC395564, AMC414439, AMC425373, AMC429963,
AMC452238, AMC458030, AMC458210

CERTIFIED MAIL - RETURN RECEIPT REQUESTED 9214 8901 9403 8321 8501 88

DECISION

OWEN WILDMAN
PO BOX 1238
MAYER, AZ 86333-1238

AMC390560, AMC390605, AMC395564, AMC414439, AMC425373, AMC429963,
AMC452238, AMC458030, AMC458210
PIANO MAN, SWINDLER NORTH, FORBACH PONDS BENCH, PIANO MAN 2,
LOADED FOR BEAR, CHAPARRAL GULCH, DOUBLE L, UNION 3, SILVER QUEEN

Maintenance Fee Waiver Certifications Denied Mining Claims Declared Forfeited

The Maintenance Fee Waiver Certifications (small miner waivers) filed for the 2021 assessment year, for the mining claims listed above, are denied. Because the small miner waivers are denied and because the required maintenance fee payments due on or before September 1, 2020, were not paid, these claims are declared forfeited.

The Bureau of Land Management's (BLM) regulations at 43 CFR 3830.21, and 3834.11(a)(2) state that by September 1 of each year, holders of mining claims must pay an annual maintenance fee of \$165 per claim per 20 acres or portion thereof. In lieu of paying the required maintenance fee, claimants may submit a valid small miner waiver, in accordance with 43 CFR 3835.1, 3835.10, and 3835.11.

In accordance with 43 CFR 3835.1(b), to qualify for a small miner waiver, you and all related parties must hold no more than a total of 10 mining claims or sites nationwide. As defined at

43 CFR 3830.5, "related party means: a) the spouse and dependent children of the claimant as defined in section 152 of the Internal Revenue Code of 1986 [26 U.S.C. section 152]; or, b) A person who controls, is controlled by, or is under common control with the claimant." "Control means actual control, legal control, or the power to exercise control, through or by common directors, officers, stockholders, a voting trust, or a holding company or Investment Company, or any other means."

Small miner waivers were filed for the seventeen mining claims listed above. The BLM has reviewed the case files for each of the mining claims listed above to verify that the owners qualify for a small miner waiver. The BLM has made the following findings:

1. Arizona Corporate Commission documents show that Big Bug Mining District LLC is a corporation registered in Arizona, dating back to 2017. According to Arizona Corporate Commission documents, the current statutory agent is Timothy Hayden. Listed as the current managing members are Dale C. Bennett, Owen Wildman, Gerald A. Baker, and Philip L. Condrey.
2. Big Bug Mining District LLC owns 10 mining claims in Arizona. The 2021 maintenance fees were paid on these claims. The claim numbers are AMC437424, AMC439458, AMC440507, AMC443155, AMC445640, AMC452459, AMC452460, AMC452461, AMC457154, AMC457155.
3. The current mailing address BLM has for Big Bug Mining District LLC is PO Box 1238, Mayer, AZ 86333-1238. This is the same address on file for Owen Wildman.
4. Ownership of the mining claims is shown on an enclosure.

In accordance with 43 C.F.R. 3835.92(d), because you or a co-claimant own more than 10 mining claims or sites and submitted a small miner waiver request and failed to pay the required maintenance fee on or before the due date for the 2021 assessment year, the mining claims listed above are declared forfeited and void as of September 1, 2020. Additionally you and the co-claimants may be subject to criminal penalties under 18 U.S.C. 1001.

Reclamation Requirements

This decision does not relieve you of the liability for reclamation of all areas disturbed by your activities on lands covered by the subject mining claim(s) and/or site(s). After you complete the reclamation, you must notify the authorized officer of the appropriate surface managing agency so that the authorized officer may conduct a final site inspection and determine whether you may be released from liability. If you fail to reclaim the land to the satisfaction of the authorized officer, the surface management agency may cite you for noncompliance under its surface management regulations.

For land administered by the BLM, if you fail to reclaim the land to the satisfaction of the authorized officer as required in 43 CFR Subpart 3809, the BLM will issue an order of noncompliance under 43 CFR 3809.601(a). If you fail to comply with the noncompliance

order, the BLM may take further action under 43 CFR 3809.604. Failure to conduct reclamation is a prohibited act that may subject you to criminal penalties. (See 43 CFR 3809.605(h) and 43 CFR 3809.700)

Appeal Procedures

This decision may be appealed to the Interior Board of Land Appeals (IBLA), Office of the Secretary, in accordance with the regulations contained in 43 CFR Part 4, and the enclosed Form 1842-1. If an appeal is taken, your notice of appeal must be filed in this office (at the above address) within 30 days from receipt of this decision. The appellant has the burden of showing that the decision appealed from is in error.

If you wish to file a petition pursuant to regulation 43 CFR 4.21 (58 FR 4939, January 19, 1993) for a stay of the effectiveness of this decision during the time that your appeal is being reviewed by the Board, the petition for a stay must accompany your notice of appeal. A petition for a stay is required to show sufficient justification based on the standards listed below. Copies of the notice of appeal and petition for a stay must also be submitted to each party named in this decision and to the IBLA and to the appropriate Office of the Solicitor (see 43 CFR 4.413) at the same time the original documents are filed with this office. If you request a stay, you have the burden of proof to demonstrate that a stay should be granted.

Standards for Obtaining a Stay

Except as otherwise provided by law or other pertinent regulation, a petition for a stay of a decision pending appeal shall show sufficient justification based on the following standards:

- (1) The relative harm to the parties if the stay is granted or denied,
- (2) The likelihood of the appellant's success on the merits,
- (3) The likelihood of immediate and irreparable harm if the stay is not granted, and
- (4) Whether the public interest favors granting the stay.

Please include your AMC serial number(s) on all correspondence. If additional information is required, please contact RéAnn Myers at 602-417-9413.

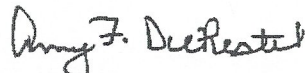

Amy F. DePestel
Supervisory Land Law Examiner
Lands, Minerals and Energy Division

Enclosures



Date Produced: 10/12/2020

ConnectSuite Inc.:

The following is the delivery information for Certified Mail™/RRE item number 9214 8901 9403 8321 8501 88. Our records indicate that this item was delivered on 10/06/2020 at 12:08 p.m. in MAYER, AZ 86333. The scanned image of the recipient information is provided below.

Signature of Recipient :

A handwritten signature in black ink, appearing to read "Owen Wildman".

Owen Wildman

Address of Recipient :

PO BOX 1238

MAYER, AZ 86333-1238

Thank you for selecting the Postal Service for your mailing needs. If you require additional assistance, please contact your local post office or Postal Service representative.

Sincerely,
United States Postal Service

The customer reference number shown below is not validated or endorsed by the United States Postal Service. It is solely for customer use.

Customer Reference Number: C2295416.13061749



United States Department of the Interior



BUREAU OF LAND MANAGEMENT
Arizona State Office
One North Central Avenue, Suite 800
Phoenix, Arizona 85004-4427
www.blm.gov/az/

SEP 30 2020

In Reply Refer To:

3800 (9200) RM

AMC390560, AMC390605, AMC395564, AMC414439, AMC425373, AMC429963,
AMC452238, AMC458030, AMC458210

CERTIFIED MAIL - RETURN RECEIPT REQUESTED 9214 8901 9403 8321 8501 95

DECISION

LAURIE COULTER
1108 E BLACKHAWK DR
PHOENIX, AZ 85024-4175

AMC390560, AMC390605, AMC395564, AMC414439, AMC425373, AMC429963,
AMC452238, AMC458030, AMC458210
PIANO MAN, SWINDLER NORTH, FORBACH PONDS BENCH, PIANO MAN 2,
LOADED FOR BEAR, CHAPARRAL GULCH, DOUBLE L, UNION 3, SILVER QUEEN

Maintenance Fee Waiver Certifications Denied
Mining Claims Declared Forfeited

The Maintenance Fee Waiver Certifications (small miner waivers) filed for the 2021 assessment year, for the mining claims listed above, are denied. Because the small miner waivers are denied and because the required maintenance fee payments due on or before September 1, 2020, were not paid, these claims are declared forfeited.

The Bureau of Land Management's (BLM) regulations at 43 CFR 3830.21, and 3834.11(a)(2) state that by September 1 of each year, holders of mining claims must pay an annual maintenance fee of \$165 per claim per 20 acres or portion thereof. In lieu of paying the required maintenance fee, claimants may submit a valid small miner waiver, in accordance with 43 CFR 3835.1, 3835.10, and 3835.11.

In accordance with 43 CFR 3835.1(b), to qualify for a small miner waiver, you and all related parties must hold no more than a total of 10 mining claims or sites nationwide. As defined at

43 CFR 3830.5, "related party means: a) the spouse and dependent children of the claimant as defined in section 152 of the Internal Revenue Code of 1986 [26 U.S.C. section 152]; or, b) A person who controls, is controlled by, or is under common control with the claimant." "Control means actual control, legal control, or the power to exercise control, through or by common directors, officers, stockholders, a voting trust, or a holding company or Investment Company, or any other means."

Small miner waivers were filed for the seventeen mining claims listed above. The BLM has reviewed the case files for each of the mining claims listed above to verify that the owners qualify for a small miner waiver. The BLM has made the following findings:

1. Arizona Corporate Commission documents show that Big Bug Mining District LLC is a corporation registered in Arizona, dating back to 2017. According to Arizona Corporate Commission documents, the current statutory agent is Timothy Hayden. Listed as the current managing members are Dale C. Bennett, Owen Wildman, Gerald A. Baker, and Philip L. Condrey.
2. Big Bug Mining District LLC owns 10 mining claims in Arizona. The 2021 maintenance fees were paid on these claims. The claim numbers are AMC437424, AMC439458, AMC440507, AMC443155, AMC445640, AMC452459, AMC452460, AMC452461, AMC457154, AMC457155.
3. The current mailing address BLM has for Big Bug Mining District LLC is PO Box 1238, Mayer, AZ 86333-1238. This is the same address on file for Owen Wildman.
4. Ownership of the mining claims is shown on an enclosure.

In accordance with 43 C.F.R. 3835.92(d), because you or a co-claimant own more than 10 mining claims or sites and submitted a small miner waiver request and failed to pay the required maintenance fee on or before the due date for the 2021 assessment year, the mining claims listed above are declared forfeited and void as of September 1, 2020. Additionally you and the co-claimants may be subject to criminal penalties under 18 U.S.C. 1001.

Reclamation Requirements

This decision does not relieve you of the liability for reclamation of all areas disturbed by your activities on lands covered by the subject mining claim(s) and/or site(s). After you complete the reclamation, you must notify the authorized officer of the appropriate surface managing agency so that the authorized officer may conduct a final site inspection and determine whether you may be released from liability. If you fail to reclaim the land to the satisfaction of the authorized officer, the surface management agency may cite you for noncompliance under its surface management regulations.

For land administered by the BLM, if you fail to reclaim the land to the satisfaction of the authorized officer as required in 43 CFR Subpart 3809, the BLM will issue an order of noncompliance under 43 CFR 3809.601(a). If you fail to comply with the noncompliance

order, the BLM may take further action under 43 CFR 3809.604. Failure to conduct reclamation is a prohibited act that may subject you to criminal penalties. (See 43 CFR 3809.605(h) and 43 CFR 3809.700)

Appeal Procedures

This decision may be appealed to the Interior Board of Land Appeals (IBLA), Office of the Secretary, in accordance with the regulations contained in 43 CFR Part 4, and the enclosed Form 1842-1. If an appeal is taken, your notice of appeal must be filed in this office (at the above address) within 30 days from receipt of this decision. The appellant has the burden of showing that the decision appealed from is in error.

If you wish to file a petition pursuant to regulation 43 CFR 4.21 (58 FR 4939, January 19, 1993) for a stay of the effectiveness of this decision during the time that your appeal is being reviewed by the Board, the petition for a stay must accompany your notice of appeal. A petition for a stay is required to show sufficient justification based on the standards listed below. Copies of the notice of appeal and petition for a stay must also be submitted to each party named in this decision and to the IBLA and to the appropriate Office of the Solicitor (see 43 CFR 4.413) at the same time the original documents are filed with this office. If you request a stay, you have the burden of proof to demonstrate that a stay should be granted.

Standards for Obtaining a Stay

Except as otherwise provided by law or other pertinent regulation, a petition for a stay of a decision pending appeal shall show sufficient justification based on the following standards:

- (1) The relative harm to the parties if the stay is granted or denied,
- (2) The likelihood of the appellant's success on the merits,
- (3) The likelihood of immediate and irreparable harm if the stay is not granted, and
- (4) Whether the public interest favors granting the stay.

Please include your AMC serial number(s) on all correspondence. If additional information is required, please contact RéAnn Myers at 602-417-9413.

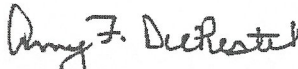
Amy F. DePestel
Supervisory Land Law Examiner
Lands, Minerals and Energy Division

Enclosures



Date Produced: 10/05/2020

ConnectSuite Inc.:

The following is the delivery information for Certified Mail™/RRE item number 9214 8901 9403 8321 8501 95. Our records indicate that this item was delivered on 10/03/2020 at 04:01 p.m. in PHOENIX, AZ 85024. The scanned image of the recipient information is provided below.

Signature of Recipient :

Con / 9
24/24 [Signature]

Address of Recipient :

1408 BLACKWATER

Thank you for selecting the Postal Service for your mailing needs. If you require additional assistance, please contact your local post office or Postal Service representative.

Sincerely,
United States Postal Service

The customer reference number shown below is not validated or endorsed by the United States Postal Service. It is solely for customer use.

Customer Reference Number: C2295416.13061750



United States Department of the Interior



BUREAU OF LAND MANAGEMENT

Arizona State Office

One North Central Avenue, Suite 800

Phoenix, Arizona 85004-4427

www.blm.gov/az/

SEP 30 2020

In Reply Refer To:

3800 (9200) RM

AMC390560, AMC390605, AMC395564, AMC414439, AMC425373, AMC429963,
AMC452238, AMC458030, AMC458210

CERTIFIED MAIL - RETURN RECEIPT REQUESTED 9214 8901 9403 8321 8502 01

DECISION

RANDY PYLE
921 GOODWIN DR
PLANO, TX 75023-4904

AMC390560, AMC390605, AMC395564, AMC414439, AMC425373, AMC429963,
AMC452238, AMC458030, AMC458210
PIANO MAN, SWINDLER NORTH, FORBACH PONDS BENCH, PIANO MAN 2,
LOADED FOR BEAR, CHAPARRAL GULCH, DOUBLE L, UNION 3, SILVER QUEEN

Maintenance Fee Waiver Certifications Denied Mining Claims Declared Forfeited

The Maintenance Fee Waiver Certifications (small miner waivers) filed for the 2021 assessment year, for the mining claims listed above, are denied. Because the small miner waivers are denied and because the required maintenance fee payments due on or before September 1, 2020, were not paid, these claims are declared forfeited.

The Bureau of Land Management's (BLM) regulations at 43 CFR 3830.21, and 3834.11(a)(2) state that by September 1 of each year, holders of mining claims must pay an annual maintenance fee of \$165 per claim per 20 acres or portion thereof. In lieu of paying the required maintenance fee, claimants may submit a valid small miner waiver, in accordance with 43 CFR 3835.1, 3835.10, and 3835.11.

In accordance with 43 CFR 3835.1(b), to qualify for a small miner waiver, you and all related parties must hold no more than a total of 10 mining claims or sites nationwide. As defined at

43 CFR 3830.5, "related party means: a) the spouse and dependent children of the claimant as defined in section 152 of the Internal Revenue Code of 1986 [26 U.S.C. section 152]; or, b) A person who controls, is controlled by, or is under common control with the claimant." "Control means actual control, legal control, or the power to exercise control, through or by common directors, officers, stockholders, a voting trust, or a holding company or Investment Company, or any other means."

Small miner waivers were filed for the seventeen mining claims listed above. The BLM has reviewed the case files for each of the mining claims listed above to verify that the owners qualify for a small miner waiver. The BLM has made the following findings:

1. Arizona Corporate Commission documents show that Big Bug Mining District LLC is a corporation registered in Arizona, dating back to 2017. According to Arizona Corporate Commission documents, the current statutory agent is Timothy Hayden. Listed as the current managing members are Dale C. Bennett, Owen Wildman, Gerald A. Baker, and Philip L. Condrey.
2. Big Bug Mining District LLC owns 10 mining claims in Arizona. The 2021 maintenance fees were paid on these claims. The claim numbers are AMC437424, AMC439458, AMC440507, AMC443155, AMC445640, AMC452459, AMC452460, AMC452461, AMC457154, AMC457155.
3. The current mailing address BLM has for Big Bug Mining District LLC is PO Box 1238, Mayer, AZ 86333-1238. This is the same address on file for Owen Wildman.
4. Ownership of the mining claims is shown on an enclosure.

In accordance with 43 C.F.R. 3835.92(d), because you or a co-claimant own more than 10 mining claims or sites and submitted a small miner waiver request and failed to pay the required maintenance fee on or before the due date for the 2021 assessment year, the mining claims listed above are declared forfeited and void as of September 1, 2020. Additionally you and the co-claimants may be subject to criminal penalties under 18 U.S.C. 1001.

Reclamation Requirements

This decision does not relieve you of the liability for reclamation of all areas disturbed by your activities on lands covered by the subject mining claim(s) and/or site(s). After you complete the reclamation, you must notify the authorized officer of the appropriate surface managing agency so that the authorized officer may conduct a final site inspection and determine whether you may be released from liability. If you fail to reclaim the land to the satisfaction of the authorized officer, the surface management agency may cite you for noncompliance under its surface management regulations.

For land administered by the BLM, if you fail to reclaim the land to the satisfaction of the authorized officer as required in 43 CFR Subpart 3809, the BLM will issue an order of noncompliance under 43 CFR 3809.601(a). If you fail to comply with the noncompliance

order, the BLM may take further action under 43 CFR 3809.604. Failure to conduct reclamation is a prohibited act that may subject you to criminal penalties. (See 43 CFR 3809.605(h) and 43 CFR 3809.700)

Appeal Procedures

This decision may be appealed to the Interior Board of Land Appeals (IBLA), Office of the Secretary, in accordance with the regulations contained in 43 CFR Part 4, and the enclosed Form 1842-1. If an appeal is taken, your notice of appeal must be filed in this office (at the above address) within 30 days from receipt of this decision. The appellant has the burden of showing that the decision appealed from is in error.

If you wish to file a petition pursuant to regulation 43 CFR 4.21 (58 FR 4939, January 19, 1993) for a stay of the effectiveness of this decision during the time that your appeal is being reviewed by the Board, the petition for a stay must accompany your notice of appeal. A petition for a stay is required to show sufficient justification based on the standards listed below. Copies of the notice of appeal and petition for a stay must also be submitted to each party named in this decision and to the IBLA and to the appropriate Office of the Solicitor (see 43 CFR 4.413) at the same time the original documents are filed with this office. If you request a stay, you have the burden of proof to demonstrate that a stay should be granted.

Standards for Obtaining a Stay

Except as otherwise provided by law or other pertinent regulation, a petition for a stay of a decision pending appeal shall show sufficient justification based on the following standards:

- (1) The relative harm to the parties if the stay is granted or denied,
- (2) The likelihood of the appellant's success on the merits,
- (3) The likelihood of immediate and irreparable harm if the stay is not granted, and
- (4) Whether the public interest favors granting the stay.

Please include your AMC serial number(s) on all correspondence. If additional information is required, please contact RéAnn Myers at 602-417-9413.

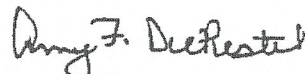

Amy F. DePestel
Supervisory Land Law Examiner
Lands, Minerals and Energy Division

Enclosures



United States Department of the Interior



BUREAU OF LAND MANAGEMENT
Arizona State Office
One North Central Avenue, Suite 800
Phoenix, Arizona 85004-4427
www.blm.gov/az/

SEP 30 2020

In Reply Refer To:

3800 (9200) RM

AMC390560, AMC390605, AMC395564, AMC414439, AMC425373, AMC429963,
AMC452238, AMC458030, AMC458210

CERTIFIED MAIL - RETURN RECEIPT REQUESTED 9214 8901 9403 8321 8502 18

DECISION

GAIL THOMPSON
2921 W YOUNG
SHOW LOW, AZ 85901-6932

AMC390560, AMC390605, AMC395564, AMC414439, AMC425373, AMC429963,
AMC452238, AMC458030, AMC458210
PIANO MAN, SWINDLER NORTH, FORBACH PONDS BENCH, PIANO MAN 2,
LOADED FOR BEAR, CHAPARRAL GULCH, DOUBLE L, UNION 3, SILVER QUEEN

Maintenance Fee Waiver Certifications Denied Mining Claims Declared Forfeited

The Maintenance Fee Waiver Certifications (small miner waivers) filed for the 2021 assessment year, for the mining claims listed above, are denied. Because the small miner waivers are denied and because the required maintenance fee payments due on or before September 1, 2020, were not paid, these claims are declared forfeited.

The Bureau of Land Management's (BLM) regulations at 43 CFR 3830.21, and 3834.11(a)(2) state that by September 1 of each year, holders of mining claims must pay an annual maintenance fee of \$165 per claim per 20 acres or portion thereof. In lieu of paying the required maintenance fee, claimants may submit a valid small miner waiver, in accordance with 43 CFR 3835.1, 3835.10, and 3835.11.

In accordance with 43 CFR 3835.1(b), to qualify for a small miner waiver, you and all related parties must hold no more than a total of 10 mining claims or sites nationwide. As defined at

43 CFR 3830.5, "related party means: a) the spouse and dependent children of the claimant as defined in section 152 of the Internal Revenue Code of 1986 [26 U.S.C. section 152]; or, b) A person who controls, is controlled by, or is under common control with the claimant." "Control means actual control, legal control, or the power to exercise control, through or by common directors, officers, stockholders, a voting trust, or a holding company or Investment Company, or any other means."

Small miner waivers were filed for the seventeen mining claims listed above. The BLM has reviewed the case files for each of the mining claims listed above to verify that the owners qualify for a small miner waiver. The BLM has made the following findings:

1. Arizona Corporate Commission documents show that Big Bug Mining District LLC is a corporation registered in Arizona, dating back to 2017. According to Arizona Corporate Commission documents, the current statutory agent is Timothy Hayden. Listed as the current managing members are Dale C. Bennett, Owen Wildman, Gerald A. Baker, and Philip L. Condrey.
2. Big Bug Mining District LLC owns 10 mining claims in Arizona. The 2021 maintenance fees were paid on these claims. The claim numbers are AMC437424, AMC439458, AMC440507, AMC443155, AMC445640, AMC452459, AMC452460, AMC452461, AMC457154, AMC457155.
3. The current mailing address BLM has for Big Bug Mining District LLC is PO Box 1238, Mayer, AZ 86333-1238. This is the same address on file for Owen Wildman.
4. Ownership of the mining claims is shown on an enclosure.

In accordance with 43 C.F.R. 3835.92(d), because you or a co-claimant own more than 10 mining claims or sites and submitted a small miner waiver request and failed to pay the required maintenance fee on or before the due date for the 2021 assessment year, the mining claims listed above are declared forfeited and void as of September 1, 2020. Additionally you and the co-claimants may be subject to criminal penalties under 18 U.S.C. 1001.

Reclamation Requirements

This decision does not relieve you of the liability for reclamation of all areas disturbed by your activities on lands covered by the subject mining claim(s) and/or site(s). After you complete the reclamation, you must notify the authorized officer of the appropriate surface managing agency so that the authorized officer may conduct a final site inspection and determine whether you may be released from liability. If you fail to reclaim the land to the satisfaction of the authorized officer, the surface management agency may cite you for noncompliance under its surface management regulations.

For land administered by the BLM, if you fail to reclaim the land to the satisfaction of the authorized officer as required in 43 CFR Subpart 3809, the BLM will issue an order of noncompliance under 43 CFR 3809.601(a). If you fail to comply with the noncompliance

order, the BLM may take further action under 43 CFR 3809.604. Failure to conduct reclamation is a prohibited act that may subject you to criminal penalties. (See 43 CFR 3809.605(h) and 43 CFR 3809.700)

Appeal Procedures

This decision may be appealed to the Interior Board of Land Appeals (IBLA), Office of the Secretary, in accordance with the regulations contained in 43 CFR Part 4, and the enclosed Form 1842-1. If an appeal is taken, your notice of appeal must be filed in this office (at the above address) within 30 days from receipt of this decision. The appellant has the burden of showing that the decision appealed from is in error.

If you wish to file a petition pursuant to regulation 43 CFR 4.21 (58 FR 4939, January 19, 1993) for a stay of the effectiveness of this decision during the time that your appeal is being reviewed by the Board, the petition for a stay must accompany your notice of appeal. A petition for a stay is required to show sufficient justification based on the standards listed below. Copies of the notice of appeal and petition for a stay must also be submitted to each party named in this decision and to the IBLA and to the appropriate Office of the Solicitor (see 43 CFR 4.413) at the same time the original documents are filed with this office. If you request a stay, you have the burden of proof to demonstrate that a stay should be granted.

Standards for Obtaining a Stay

Except as otherwise provided by law or other pertinent regulation, a petition for a stay of a decision pending appeal shall show sufficient justification based on the following standards:

- (1) The relative harm to the parties if the stay is granted or denied,
- (2) The likelihood of the appellant's success on the merits,
- (3) The likelihood of immediate and irreparable harm if the stay is not granted, and
- (4) Whether the public interest favors granting the stay.

Please include your AMC serial number(s) on all correspondence. If additional information is required, please contact RéAnn Myers at 602-417-9413.

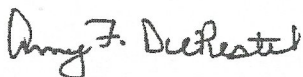
Amy F. DePestel
Supervisory Land Law Examiner
Lands, Minerals and Energy Division

Enclosures



United States Department of the Interior



BUREAU OF LAND MANAGEMENT

Arizona State Office

One North Central Avenue, Suite 800

Phoenix, Arizona 85004-4427

www.blm.gov/az/

SEP 30 2020

In Reply Refer To:

3800 (9200) RM

AMC390560, AMC390605, AMC395564, AMC414439, AMC425373, AMC429963,
AMC452238, AMC458030, AMC458210

CERTIFIED MAIL - RETURN RECEIPT REQUESTED 9214 8901 9403 8321 8502 25

DECISION

BOBBY SHEARON

PO BOX 325

DEWEY, AZ 86327-0325

AMC390560, AMC390605, AMC395564, AMC414439, AMC425373, AMC429963,
AMC452238, AMC458030, AMC458210

PIANO MAN, SWINDLER NORTH, FORBACH PONDS BENCH, PIANO MAN 2,
LOADED FOR BEAR, CHAPARRAL GULCH, DOUBLE L, UNION 3, SILVER QUEEN

Maintenance Fee Waiver Certifications Denied Mining Claims Declared Forfeited

The Maintenance Fee Waiver Certifications (small miner waivers) filed for the 2021 assessment year, for the mining claims listed above, are denied. Because the small miner waivers are denied and because the required maintenance fee payments due on or before September 1, 2020, were not paid, these claims are declared forfeited.

The Bureau of Land Management's (BLM) regulations at 43 CFR 3830.21, and 3834.11(a)(2) state that by September 1 of each year, holders of mining claims must pay an annual maintenance fee of \$165 per claim per 20 acres or portion thereof. In lieu of paying the required maintenance fee, claimants may submit a valid small miner waiver, in accordance with 43 CFR 3835.1, 3835.10, and 3835.11.

In accordance with 43 CFR 3835.1(b), to qualify for a small miner waiver, you and all related parties must hold no more than a total of 10 mining claims or sites nationwide. As defined at

43 CFR 3830.5, "related party means: a) the spouse and dependent children of the claimant as defined in section 152 of the Internal Revenue Code of 1986 [26 U.S.C. section 152]; or, b) A person who controls, is controlled by, or is under common control with the claimant." "Control means actual control, legal control, or the power to exercise control, through or by common directors, officers, stockholders, a voting trust, or a holding company or Investment Company, or any other means."

Small miner waivers were filed for the seventeen mining claims listed above. The BLM has reviewed the case files for each of the mining claims listed above to verify that the owners qualify for a small miner waiver. The BLM has made the following findings:

1. Arizona Corporate Commission documents show that Big Bug Mining District LLC is a corporation registered in Arizona, dating back to 2017. According to Arizona Corporate Commission documents, the current statutory agent is Timothy Hayden. Listed as the current managing members are Dale C. Bennett, Owen Wildman, Gerald A. Baker, and Philip L. Condrey.
2. Big Bug Mining District LLC owns 10 mining claims in Arizona. The 2021 maintenance fees were paid on these claims. The claim numbers are AMC437424, AMC439458, AMC440507, AMC443155, AMC445640, AMC452459, AMC452460, AMC452461, AMC457154, AMC457155.
3. The current mailing address BLM has for Big Bug Mining District LLC is PO Box 1238, Mayer, AZ 86333-1238. This is the same address on file for Owen Wildman.
4. Ownership of the mining claims is shown on an enclosure.

In accordance with 43 C.F.R. 3835.92(d), because you or a co-claimant own more than 10 mining claims or sites and submitted a small miner waiver request and failed to pay the required maintenance fee on or before the due date for the 2021 assessment year, the mining claims listed above are declared forfeited and void as of September 1, 2020. Additionally you and the co-claimants may be subject to criminal penalties under 18 U.S.C. 1001.

Reclamation Requirements

This decision does not relieve you of the liability for reclamation of all areas disturbed by your activities on lands covered by the subject mining claim(s) and/or site(s). After you complete the reclamation, you must notify the authorized officer of the appropriate surface managing agency so that the authorized officer may conduct a final site inspection and determine whether you may be released from liability. If you fail to reclaim the land to the satisfaction of the authorized officer, the surface management agency may cite you for noncompliance under its surface management regulations.

For land administered by the BLM, if you fail to reclaim the land to the satisfaction of the authorized officer as required in 43 CFR Subpart 3809, the BLM will issue an order of noncompliance under 43 CFR 3809.601(a). If you fail to comply with the noncompliance

order, the BLM may take further action under 43 CFR 3809.604. Failure to conduct reclamation is a prohibited act that may subject you to criminal penalties. (See 43 CFR 3809.605(h) and 43 CFR 3809.700)

Appeal Procedures

This decision may be appealed to the Interior Board of Land Appeals (IBLA), Office of the Secretary, in accordance with the regulations contained in 43 CFR Part 4, and the enclosed Form 1842-1. If an appeal is taken, your notice of appeal must be filed in this office (at the above address) within 30 days from receipt of this decision. The appellant has the burden of showing that the decision appealed from is in error.

If you wish to file a petition pursuant to regulation 43 CFR 4.21 (58 FR 4939, January 19, 1993) for a stay of the effectiveness of this decision during the time that your appeal is being reviewed by the Board, the petition for a stay must accompany your notice of appeal. A petition for a stay is required to show sufficient justification based on the standards listed below. Copies of the notice of appeal and petition for a stay must also be submitted to each party named in this decision and to the IBLA and to the appropriate Office of the Solicitor (see 43 CFR 4.413) at the same time the original documents are filed with this office. If you request a stay, you have the burden of proof to demonstrate that a stay should be granted.

Standards for Obtaining a Stay

Except as otherwise provided by law or other pertinent regulation, a petition for a stay of a decision pending appeal shall show sufficient justification based on the following standards:

- (1) The relative harm to the parties if the stay is granted or denied,
- (2) The likelihood of the appellant's success on the merits,
- (3) The likelihood of immediate and irreparable harm if the stay is not granted, and
- (4) Whether the public interest favors granting the stay.

Please include your AMC serial number(s) on all correspondence. If additional information is required, please contact RéAnn Myers at 602-417-9413.

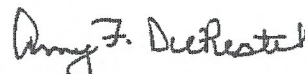

Amy F. DePestel
Supervisory Land Law Examiner
Lands, Minerals and Energy Division

Enclosures



Date Produced: 10/12/2020

ConnectSuite Inc.:

The following is the delivery information for Certified Mail™/RRE item number 9214 8901 9403 8321 8502 25. Our records indicate that this item was delivered on 10/05/2020 at 11:59 a.m. in DEWEY, AZ 86327. The scanned image of the recipient information is provided below.

Signature of Recipient :

A handwritten signature in black ink, appearing to be "Bobby S H 29260".

Bobby S H 29260

Address of Recipient :

PO BOX 325

DEWEY, AZ 86327-0325

Thank you for selecting the Postal Service for your mailing needs. If you require additional assistance, please contact your local post office or Postal Service representative.

Sincerely,
United States Postal Service

The customer reference number shown below is not validated or endorsed by the United States Postal Service. It is solely for customer use.

Customer Reference Number: C2295416.13061753



United States Department of the Interior

BUREAU OF LAND MANAGEMENT
Arizona State Office
One North Central Avenue, Suite 800
Phoenix, Arizona 85004-4427
www.blm.gov/az/



SEP 30 2020

In Reply Refer To:

3800 (9200) RM

AMC390560, AMC390605, AMC395564, AMC414439, AMC425373, AMC429963,
AMC452238, AMC458030, AMC458210

CERTIFIED MAIL - RETURN RECEIPT REQUESTED 9214 8901 9403 8321 8502 32

DECISION

CURT BORK
PO BOX 1427
MAYER, AZ 86333-1427

AMC390560, AMC390605, AMC395564, AMC414439, AMC425373, AMC429963,
AMC452238, AMC458030, AMC458210
PIANO MAN, SWINDLER NORTH, FORBACH PONDS BENCH, PIANO MAN 2,
LOADED FOR BEAR, CHAPARRAL GULCH, DOUBLE L, UNION 3, SILVER QUEEN

Maintenance Fee Waiver Certifications Denied
Mining Claims Declared Forfeited

The Maintenance Fee Waiver Certifications (small miner waivers) filed for the 2021 assessment year, for the mining claims listed above, are denied. Because the small miner waivers are denied and because the required maintenance fee payments due on or before September 1, 2020, were not paid, these claims are declared forfeited.

The Bureau of Land Management's (BLM) regulations at 43 CFR 3830.21, and 3834.11(a)(2) state that by September 1 of each year, holders of mining claims must pay an annual maintenance fee of \$165 per claim per 20 acres or portion thereof. In lieu of paying the required maintenance fee, claimants may submit a valid small miner waiver, in accordance with 43 CFR 3835.1, 3835.10, and 3835.11.

In accordance with 43 CFR 3835.1(b), to qualify for a small miner waiver, you and all related parties must hold no more than a total of 10 mining claims or sites nationwide. As defined at

43 CFR 3830.5, "related party means: a) the spouse and dependent children of the claimant as defined in section 152 of the Internal Revenue Code of 1986 [26 U.S.C. section 152]; or, b) A person who controls, is controlled by, or is under common control with the claimant." "Control means actual control, legal control, or the power to exercise control, through or by common directors, officers, stockholders, a voting trust, or a holding company or Investment Company, or any other means."

Small miner waivers were filed for the seventeen mining claims listed above. The BLM has reviewed the case files for each of the mining claims listed above to verify that the owners qualify for a small miner waiver. The BLM has made the following findings:

1. Arizona Corporate Commission documents show that Big Bug Mining District LLC is a corporation registered in Arizona, dating back to 2017. According to Arizona Corporate Commission documents, the current statutory agent is Timothy Hayden. Listed as the current managing members are Dale C. Bennett, Owen Wildman, Gerald A. Baker, and Philip L. Condrey.
2. Big Bug Mining District LLC owns 10 mining claims in Arizona. The 2021 maintenance fees were paid on these claims. The claim numbers are AMC437424, AMC439458, AMC440507, AMC443155, AMC445640, AMC452459, AMC452460, AMC452461, AMC457154, AMC457155.
3. The current mailing address BLM has for Big Bug Mining District LLC is PO Box 1238, Mayer, AZ 86333-1238. This is the same address on file for Owen Wildman.
4. Ownership of the mining claims is shown on an enclosure.

In accordance with 43 C.F.R. 3835.92(d), because you or a co-claimant own more than 10 mining claims or sites and submitted a small miner waiver request and failed to pay the required maintenance fee on or before the due date for the 2021 assessment year, the mining claims listed above are declared forfeited and void as of September 1, 2020. Additionally you and the co-claimants may be subject to criminal penalties under 18 U.S.C. 1001.

Reclamation Requirements

This decision does not relieve you of the liability for reclamation of all areas disturbed by your activities on lands covered by the subject mining claim(s) and/or site(s). After you complete the reclamation, you must notify the authorized officer of the appropriate surface managing agency so that the authorized officer may conduct a final site inspection and determine whether you may be released from liability. If you fail to reclaim the land to the satisfaction of the authorized officer, the surface management agency may cite you for noncompliance under its surface management regulations.

For land administered by the BLM, if you fail to reclaim the land to the satisfaction of the authorized officer as required in 43 CFR Subpart 3809, the BLM will issue an order of noncompliance under 43 CFR 3809.601(a). If you fail to comply with the noncompliance

order, the BLM may take further action under 43 CFR 3809.604. Failure to conduct reclamation is a prohibited act that may subject you to criminal penalties. (See 43 CFR 3809.605(h) and 43 CFR 3809.700)

Appeal Procedures

This decision may be appealed to the Interior Board of Land Appeals (IBLA), Office of the Secretary, in accordance with the regulations contained in 43 CFR Part 4, and the enclosed Form 1842-1. If an appeal is taken, your notice of appeal must be filed in this office (at the above address) within 30 days from receipt of this decision. The appellant has the burden of showing that the decision appealed from is in error.

If you wish to file a petition pursuant to regulation 43 CFR 4.21 (58 FR 4939, January 19, 1993) for a stay of the effectiveness of this decision during the time that your appeal is being reviewed by the Board, the petition for a stay must accompany your notice of appeal. A petition for a stay is required to show sufficient justification based on the standards listed below. Copies of the notice of appeal and petition for a stay must also be submitted to each party named in this decision and to the IBLA and to the appropriate Office of the Solicitor (see 43 CFR 4.413) at the same time the original documents are filed with this office. If you request a stay, you have the burden of proof to demonstrate that a stay should be granted.

Standards for Obtaining a Stay

Except as otherwise provided by law or other pertinent regulation, a petition for a stay of a decision pending appeal shall show sufficient justification based on the following standards:

- (1) The relative harm to the parties if the stay is granted or denied,
- (2) The likelihood of the appellant's success on the merits,
- (3) The likelihood of immediate and irreparable harm if the stay is not granted, and
- (4) Whether the public interest favors granting the stay.

Please include your AMC serial number(s) on all correspondence. If additional information is required, please contact RéAnn Myers at 602-417-9413.

Amy F. DePestel
Supervisory Land Law Examiner
Lands, Minerals and Energy Division

Enclosures



Date Produced: 10/12/2020

ConnectSuite Inc.:

The following is the delivery information for Certified Mail™/RRE item number 9214 8901 9403 8321 8502 32. Our records indicate that this item was delivered on 10/05/2020 at 03:35 p.m. in MAYER, AZ 86333. The scanned image of the recipient information is provided below.

Signature of Recipient :

CURTIS D. BORK

Address of Recipient :

PO BOX 1427

MAYER, AZ 86333-1427

Thank you for selecting the Postal Service for your mailing needs. If you require additional assistance, please contact your local post office or Postal Service representative.

Sincerely,
United States Postal Service

The customer reference number shown below is not validated or endorsed by the United States Postal Service. It is solely for customer use.

Customer Reference Number: C2295416.13061754



United States Department of the Interior

BUREAU OF LAND MANAGEMENT

Arizona State Office

One North Central Avenue, Suite 800

Phoenix, Arizona 85004-4427

www.blm.gov/az/

SEP 30 2020



In Reply Refer To:

3800 (9200) RM

AMC390560, AMC390605, AMC395564, AMC414439, AMC425373, AMC429963,
AMC452238, AMC458030, AMC458210

CERTIFIED MAIL - RETURN RECEIPT REQUESTED 9214 8901 9403 8321 8502 49

DECISION

BRANDON GERLACH
PO BOX 872
HUMBOLDT, AZ 86329-0872

AMC390560, AMC390605, AMC395564, AMC414439, AMC425373, AMC429963,
AMC452238, AMC458030, AMC458210
PIANO MAN, SWINDLER NORTH, FORBACH PONDS BENCH, PIANO MAN 2,
LOADED FOR BEAR, CHAPARRAL GULCH, DOUBLE L, UNION 3, SILVER QUEEN

Maintenance Fee Waiver Certifications Denied Mining Claims Declared Forfeited

The Maintenance Fee Waiver Certifications (small miner waivers) filed for the 2021 assessment year, for the mining claims listed above, are denied. Because the small miner waivers are denied and because the required maintenance fee payments due on or before September 1, 2020, were not paid, these claims are declared forfeited.

The Bureau of Land Management's (BLM) regulations at 43 CFR 3830.21, and 3834.11(a)(2) state that by September 1 of each year, holders of mining claims must pay an annual maintenance fee of \$165 per claim per 20 acres or portion thereof. In lieu of paying the required maintenance fee, claimants may submit a valid small miner waiver, in accordance with 43 CFR 3835.1, 3835.10, and 3835.11.

In accordance with 43 CFR 3835.1(b), to qualify for a small miner waiver, you and all related parties must hold no more than a total of 10 mining claims or sites nationwide. As defined at

43 CFR 3830.5, "related party means: a) the spouse and dependent children of the claimant as defined in section 152 of the Internal Revenue Code of 1986 [26 U.S.C. section 152]; or, b) A person who controls, is controlled by, or is under common control with the claimant." "Control means actual control, legal control, or the power to exercise control, through or by common directors, officers, stockholders, a voting trust, or a holding company or Investment Company, or any other means."

Small miner waivers were filed for the seventeen mining claims listed above. The BLM has reviewed the case files for each of the mining claims listed above to verify that the owners qualify for a small miner waiver. The BLM has made the following findings:

1. Arizona Corporate Commission documents show that Big Bug Mining District LLC is a corporation registered in Arizona, dating back to 2017. According to Arizona Corporate Commission documents, the current statutory agent is Timothy Hayden. Listed as the current managing members are Dale C. Bennett, Owen Wildman, Gerald A. Baker, and Philip L. Condrey.
2. Big Bug Mining District LLC owns 10 mining claims in Arizona. The 2021 maintenance fees were paid on these claims. The claim numbers are AMC437424, AMC439458, AMC440507, AMC443155, AMC445640, AMC452459, AMC452460, AMC452461, AMC457154, AMC457155.
3. The current mailing address BLM has for Big Bug Mining District LLC is PO Box 1238, Mayer, AZ 86333-1238. This is the same address on file for Owen Wildman.
4. Ownership of the mining claims is shown on an enclosure.

In accordance with 43 C.F.R. 3835.92(d), because you or a co-claimant own more than 10 mining claims or sites and submitted a small miner waiver request and failed to pay the required maintenance fee on or before the due date for the 2021 assessment year, the mining claims listed above are declared forfeited and void as of September 1, 2020. Additionally you and the co-claimants may be subject to criminal penalties under 18 U.S.C. 1001.

Reclamation Requirements

This decision does not relieve you of the liability for reclamation of all areas disturbed by your activities on lands covered by the subject mining claim(s) and/or site(s). After you complete the reclamation, you must notify the authorized officer of the appropriate surface managing agency so that the authorized officer may conduct a final site inspection and determine whether you may be released from liability. If you fail to reclaim the land to the satisfaction of the authorized officer, the surface management agency may cite you for noncompliance under its surface management regulations.

For land administered by the BLM, if you fail to reclaim the land to the satisfaction of the authorized officer as required in 43 CFR Subpart 3809, the BLM will issue an order of noncompliance under 43 CFR 3809.601(a). If you fail to comply with the noncompliance

order, the BLM may take further action under 43 CFR 3809.604. Failure to conduct reclamation is a prohibited act that may subject you to criminal penalties. (See 43 CFR 3809.605(h) and 43 CFR 3809.700)

Appeal Procedures

This decision may be appealed to the Interior Board of Land Appeals (IBLA), Office of the Secretary, in accordance with the regulations contained in 43 CFR Part 4, and the enclosed Form 1842-1. If an appeal is taken, your notice of appeal must be filed in this office (at the above address) within 30 days from receipt of this decision. The appellant has the burden of showing that the decision appealed from is in error.

If you wish to file a petition pursuant to regulation 43 CFR 4.21 (58 FR 4939, January 19, 1993) for a stay of the effectiveness of this decision during the time that your appeal is being reviewed by the Board, the petition for a stay must accompany your notice of appeal. A petition for a stay is required to show sufficient justification based on the standards listed below. Copies of the notice of appeal and petition for a stay must also be submitted to each party named in this decision and to the IBLA and to the appropriate Office of the Solicitor (see 43 CFR 4.413) at the same time the original documents are filed with this office. If you request a stay, you have the burden of proof to demonstrate that a stay should be granted.

Standards for Obtaining a Stay

Except as otherwise provided by law or other pertinent regulation, a petition for a stay of a decision pending appeal shall show sufficient justification based on the following standards:

- (1) The relative harm to the parties if the stay is granted or denied,
- (2) The likelihood of the appellant's success on the merits,
- (3) The likelihood of immediate and irreparable harm if the stay is not granted, and
- (4) Whether the public interest favors granting the stay.

Please include your AMC serial number(s) on all correspondence. If additional information is required, please contact RéAnn Myers at 602-417-9413.

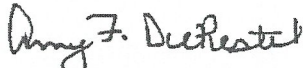
Amy F. DePestel
Supervisory Land Law Examiner
Lands, Minerals and Energy Division

Enclosures



United States Department of the Interior



BUREAU OF LAND MANAGEMENT

Arizona State Office

One North Central Avenue, Suite 800

Phoenix, Arizona 85004-4427

www.blm.gov/az/

SEP 30 2020

In Reply Refer To:

3800 (9200) RM

AMC390560, AMC390605, AMC395564, AMC414439, AMC425373, AMC429963,
AMC452238, AMC458030, AMC458210

CERTIFIED MAIL - RETURN RECEIPT REQUESTED 9214 8901 9403 8321 8502 56

DECISION

DOUG RHOADES

PO BOX 970

CHINO VALLEY, AZ 86323-0970

AMC390560, AMC390605, AMC395564, AMC414439, AMC425373, AMC429963,
AMC452238, AMC458030, AMC458210

PIANO MAN, SWINDLER NORTH, FORBACH PONDS BENCH, PIANO MAN 2,
LOADED FOR BEAR, CHAPARRAL GULCH, DOUBLE L, UNION 3, SILVER QUEEN

Maintenance Fee Waiver Certifications Denied Mining Claims Declared Forfeited

The Maintenance Fee Waiver Certifications (small miner waivers) filed for the 2021 assessment year, for the mining claims listed above, are denied. Because the small miner waivers are denied and because the required maintenance fee payments due on or before September 1, 2020, were not paid, these claims are declared forfeited.

The Bureau of Land Management's (BLM) regulations at 43 CFR 3830.21, and 3834.11(a)(2) state that by September 1 of each year, holders of mining claims must pay an annual maintenance fee of \$165 per claim per 20 acres or portion thereof. In lieu of paying the required maintenance fee, claimants may submit a valid small miner waiver, in accordance with 43 CFR 3835.1, 3835.10, and 3835.11.

In accordance with 43 CFR 3835.1(b), to qualify for a small miner waiver, you and all related parties must hold no more than a total of 10 mining claims or sites nationwide. As defined at

43 CFR 3830.5, "related party means: a) the spouse and dependent children of the claimant as defined in section 152 of the Internal Revenue Code of 1986 [26 U.S.C. section 152]; or, b) A person who controls, is controlled by, or is under common control with the claimant." "Control means actual control, legal control, or the power to exercise control, through or by common directors, officers, stockholders, a voting trust, or a holding company or Investment Company, or any other means."

Small miner waivers were filed for the seventeen mining claims listed above. The BLM has reviewed the case files for each of the mining claims listed above to verify that the owners qualify for a small miner waiver. The BLM has made the following findings:

1. Arizona Corporate Commission documents show that Big Bug Mining District LLC is a corporation registered in Arizona, dating back to 2017. According to Arizona Corporate Commission documents, the current statutory agent is Timothy Hayden. Listed as the current managing members are Dale C. Bennett, Owen Wildman, Gerald A. Baker, and Philip L. Condrey.
2. Big Bug Mining District LLC owns 10 mining claims in Arizona. The 2021 maintenance fees were paid on these claims. The claim numbers are AMC437424, AMC439458, AMC440507, AMC443155, AMC445640, AMC452459, AMC452460, AMC452461, AMC457154, AMC457155.
3. The current mailing address BLM has for Big Bug Mining District LLC is PO Box 1238, Mayer, AZ 86333-1238. This is the same address on file for Owen Wildman.
4. Ownership of the mining claims is shown on an enclosure.

In accordance with 43 C.F.R. 3835.92(d), because you or a co-claimant own more than 10 mining claims or sites and submitted a small miner waiver request and failed to pay the required maintenance fee on or before the due date for the 2021 assessment year, the mining claims listed above are declared forfeited and void as of September 1, 2020. Additionally you and the co-claimants may be subject to criminal penalties under 18 U.S.C. 1001.

Reclamation Requirements

This decision does not relieve you of the liability for reclamation of all areas disturbed by your activities on lands covered by the subject mining claim(s) and/or site(s). After you complete the reclamation, you must notify the authorized officer of the appropriate surface managing agency so that the authorized officer may conduct a final site inspection and determine whether you may be released from liability. If you fail to reclaim the land to the satisfaction of the authorized officer, the surface management agency may cite you for noncompliance under its surface management regulations.

For land administered by the BLM, if you fail to reclaim the land to the satisfaction of the authorized officer as required in 43 CFR Subpart 3809, the BLM will issue an order of noncompliance under 43 CFR 3809.601(a). If you fail to comply with the noncompliance

order, the BLM may take further action under 43 CFR 3809.604. Failure to conduct reclamation is a prohibited act that may subject you to criminal penalties. (See 43 CFR 3809.605(h) and 43 CFR 3809.700)

Appeal Procedures

This decision may be appealed to the Interior Board of Land Appeals (IBLA), Office of the Secretary, in accordance with the regulations contained in 43 CFR Part 4, and the enclosed Form 1842-1. If an appeal is taken, your notice of appeal must be filed in this office (at the above address) within 30 days from receipt of this decision. The appellant has the burden of showing that the decision appealed from is in error.

If you wish to file a petition pursuant to regulation 43 CFR 4.21 (58 FR 4939, January 19, 1993) for a stay of the effectiveness of this decision during the time that your appeal is being reviewed by the Board, the petition for a stay must accompany your notice of appeal. A petition for a stay is required to show sufficient justification based on the standards listed below. Copies of the notice of appeal and petition for a stay must also be submitted to each party named in this decision and to the IBLA and to the appropriate Office of the Solicitor (see 43 CFR 4.413) at the same time the original documents are filed with this office. If you request a stay, you have the burden of proof to demonstrate that a stay should be granted.

Standards for Obtaining a Stay

Except as otherwise provided by law or other pertinent regulation, a petition for a stay of a decision pending appeal shall show sufficient justification based on the following standards:

- (1) The relative harm to the parties if the stay is granted or denied,
- (2) The likelihood of the appellant's success on the merits,
- (3) The likelihood of immediate and irreparable harm if the stay is not granted, and
- (4) Whether the public interest favors granting the stay.

Please include your AMC serial number(s) on all correspondence. If additional information is required, please contact RéAnn Myers at 602-417-9413.

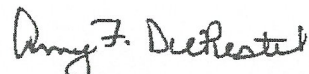

Amy F. DePestel
Supervisory Land Law Examiner
Lands, Minerals and Energy Division

Enclosures

Date Produced: 10/19/2020

ConnectSuite Inc.:

The following is the delivery information for Certified Mail™/RRE item number 9214 8901 9403 8321 8502 56. Our records indicate that this item was delivered on 10/15/2020 at 10:12 a.m. in CHINO VALLEY, AZ 86323. The scanned image of the recipient information is provided below.

Signature of Recipient :

Delivery Section

Signature	<i>Douglas Rhoades</i>
Name	<i>DOUGLAS RHOADES</i>

Address of Recipient :

Address	<i>T8B 970</i>
---------	----------------

Thank you for selecting the Postal Service for your mailing needs. If you require additional assistance, please contact your local post office or Postal Service representative.

Sincerely,
United States Postal Service

The customer reference number shown below is not validated or endorsed by the United States Postal Service. It is solely for customer use.

Customer Reference Number: C2295416.13061756



United States Department of the Interior



BUREAU OF LAND MANAGEMENT
Arizona State Office
One North Central Avenue, Suite 800
Phoenix, Arizona 85004-4427
www.blm.gov/az/

SEP 30 2020

In Reply Refer To:

3800 (9200) RM

AMC390560, AMC390605, AMC395564, AMC414439, AMC425373, AMC429963,
AMC452238, AMC458030, AMC458210

CERTIFIED MAIL - RETURN RECEIPT REQUESTED 9214 8901 9403 8321 8502 63

DECISION

ROGER GRASS
7386 E NIGHT WATCH WAY
PRESCOTT VALLEY, AZ 86314-1416

AMC390560, AMC390605, AMC395564, AMC414439, AMC425373, AMC429963,
AMC452238, AMC458030, AMC458210
PIANO MAN, SWINDLER NORTH, FORBACH PONDS BENCH, PIANO MAN 2,
LOADED FOR BEAR, CHAPARRAL GULCH, DOUBLE L, UNION 3, SILVER QUEEN

Maintenance Fee Waiver Certifications Denied Mining Claims Declared Forfeited

The Maintenance Fee Waiver Certifications (small miner waivers) filed for the 2021 assessment year, for the mining claims listed above, are denied. Because the small miner waivers are denied and because the required maintenance fee payments due on or before September 1, 2020, were not paid, these claims are declared forfeited.

The Bureau of Land Management's (BLM) regulations at 43 CFR 3830.21, and 3834.11(a)(2) state that by September 1 of each year, holders of mining claims must pay an annual maintenance fee of \$165 per claim per 20 acres or portion thereof. In lieu of paying the required maintenance fee, claimants may submit a valid small miner waiver, in accordance with 43 CFR 3835.1, 3835.10, and 3835.11.

In accordance with 43 CFR 3835.1(b), to qualify for a small miner waiver, you and all related parties must hold no more than a total of 10 mining claims or sites nationwide. As defined at

43 CFR 3830.5, "related party means: a) the spouse and dependent children of the claimant as defined in section 152 of the Internal Revenue Code of 1986 [26 U.S.C. section 152]; or, b) A person who controls, is controlled by, or is under common control with the claimant." "Control means actual control, legal control, or the power to exercise control, through or by common directors, officers, stockholders, a voting trust, or a holding company or Investment Company, or any other means."

Small miner waivers were filed for the seventeen mining claims listed above. The BLM has reviewed the case files for each of the mining claims listed above to verify that the owners qualify for a small miner waiver. The BLM has made the following findings:

1. Arizona Corporate Commission documents show that Big Bug Mining District LLC is a corporation registered in Arizona, dating back to 2017. According to Arizona Corporate Commission documents, the current statutory agent is Timothy Hayden. Listed as the current managing members are Dale C. Bennett, Owen Wildman, Gerald A. Baker, and Philip L. Condrey.
2. Big Bug Mining District LLC owns 10 mining claims in Arizona. The 2021 maintenance fees were paid on these claims. The claim numbers are AMC437424, AMC439458, AMC440507, AMC443155, AMC445640, AMC452459, AMC452460, AMC452461, AMC457154, AMC457155.
3. The current mailing address BLM has for Big Bug Mining District LLC is PO Box 1238, Mayer, AZ 86333-1238. This is the same address on file for Owen Wildman.
4. Ownership of the mining claims is shown on an enclosure.

In accordance with 43 C.F.R. 3835.92(d), because you or a co-claimant own more than 10 mining claims or sites and submitted a small miner waiver request and failed to pay the required maintenance fee on or before the due date for the 2021 assessment year, the mining claims listed above are declared forfeited and void as of September 1, 2020. Additionally you and the co-claimants may be subject to criminal penalties under 18 U.S.C. 1001.

Reclamation Requirements

This decision does not relieve you of the liability for reclamation of all areas disturbed by your activities on lands covered by the subject mining claim(s) and/or site(s). After you complete the reclamation, you must notify the authorized officer of the appropriate surface managing agency so that the authorized officer may conduct a final site inspection and determine whether you may be released from liability. If you fail to reclaim the land to the satisfaction of the authorized officer, the surface management agency may cite you for noncompliance under its surface management regulations.

For land administered by the BLM, if you fail to reclaim the land to the satisfaction of the authorized officer as required in 43 CFR Subpart 3809, the BLM will issue an order of noncompliance under 43 CFR 3809.601(a). If you fail to comply with the noncompliance

order, the BLM may take further action under 43 CFR 3809.604. Failure to conduct reclamation is a prohibited act that may subject you to criminal penalties. (See 43 CFR 3809.605(h) and 43 CFR 3809.700)

Appeal Procedures

This decision may be appealed to the Interior Board of Land Appeals (IBLA), Office of the Secretary, in accordance with the regulations contained in 43 CFR Part 4, and the enclosed Form 1842-1. If an appeal is taken, your notice of appeal must be filed in this office (at the above address) within 30 days from receipt of this decision. The appellant has the burden of showing that the decision appealed from is in error.

If you wish to file a petition pursuant to regulation 43 CFR 4.21 (58 FR 4939, January 19, 1993) for a stay of the effectiveness of this decision during the time that your appeal is being reviewed by the Board, the petition for a stay must accompany your notice of appeal. A petition for a stay is required to show sufficient justification based on the standards listed below. Copies of the notice of appeal and petition for a stay must also be submitted to each party named in this decision and to the IBLA and to the appropriate Office of the Solicitor (see 43 CFR 4.413) at the same time the original documents are filed with this office. If you request a stay, you have the burden of proof to demonstrate that a stay should be granted.

Standards for Obtaining a Stay

Except as otherwise provided by law or other pertinent regulation, a petition for a stay of a decision pending appeal shall show sufficient justification based on the following standards:

- (1) The relative harm to the parties if the stay is granted or denied,
- (2) The likelihood of the appellant's success on the merits,
- (3) The likelihood of immediate and irreparable harm if the stay is not granted, and
- (4) Whether the public interest favors granting the stay.

Please include your AMC serial number(s) on all correspondence. If additional information is required, please contact RéAnn Myers at 602-417-9413.

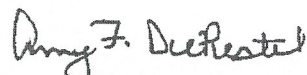

Amy F. DePestel
Supervisory Land Law Examiner
Lands, Minerals and Energy Division

Enclosures



Date Produced: 10/12/2020

ConnectSuite Inc.:

The following is the delivery information for Certified Mail™/RRE item number 9214 8901 9403 8321 8502 63. Our records indicate that this item was delivered on 10/05/2020 at 03:34 p.m. in PRESCOTT VALLEY, AZ 86314. The scanned image of the recipient information is provided below.

Signature of Recipient :

L. Bress
VA 4/9 1/9 MIC

Address of Recipient :

7596 E. N. HWY 144

Thank you for selecting the Postal Service for your mailing needs. If you require additional assistance, please contact your local post office or Postal Service representative.

Sincerely,
United States Postal Service

The customer reference number shown below is not validated or endorsed by the United States Postal Service. It is solely for customer use.

Customer Reference Number: C2295416.13061757



United States Department of the Interior



BUREAU OF LAND MANAGEMENT
Arizona State Office
One North Central Avenue, Suite 800
Phoenix, Arizona 85004-4427
www.blm.gov/az/

SEP 30 2020

In Reply Refer To:

3800 (9200) RM

AMC390560, AMC390605, AMC395564, AMC414439, AMC425373, AMC429963,
AMC452238, AMC458030, AMC458210

CERTIFIED MAIL - RETURN RECEIPT REQUESTED 9214 8901 9403 8321 8502 70

DECISION

PHILLIP CONDREY
PO BOX 684
HUMBOLDT, AZ 86329-0684

AMC390560, AMC390605, AMC395564, AMC414439, AMC425373, AMC429963,
AMC452238, AMC458030, AMC458210
PIANO MAN, SWINDLER NORTH, FORBACH PONDS BENCH, PIANO MAN 2,
LOADED FOR BEAR, CHAPARRAL GULCH, DOUBLE L, UNION 3, SILVER QUEEN

Maintenance Fee Waiver Certifications Denied Mining Claims Declared Forfeited

The Maintenance Fee Waiver Certifications (small miner waivers) filed for the 2021 assessment year, for the mining claims listed above, are denied. Because the small miner waivers are denied and because the required maintenance fee payments due on or before September 1, 2020, were not paid, these claims are declared forfeited.

The Bureau of Land Management's (BLM) regulations at 43 CFR 3830.21, and 3834.11(a)(2) state that by September 1 of each year, holders of mining claims must pay an annual maintenance fee of \$165 per claim per 20 acres or portion thereof. In lieu of paying the required maintenance fee, claimants may submit a valid small miner waiver, in accordance with 43 CFR 3835.1, 3835.10, and 3835.11.

In accordance with 43 CFR 3835.1(b), to qualify for a small miner waiver, you and all related parties must hold no more than a total of 10 mining claims or sites nationwide. As defined at

43 CFR 3830.5, "related party means: a) the spouse and dependent children of the claimant as defined in section 152 of the Internal Revenue Code of 1986 [26 U.S.C. section 152]; or, b) A person who controls, is controlled by, or is under common control with the claimant." "Control means actual control, legal control, or the power to exercise control, through or by common directors, officers, stockholders, a voting trust, or a holding company or Investment Company, or any other means."

Small miner waivers were filed for the seventeen mining claims listed above. The BLM has reviewed the case files for each of the mining claims listed above to verify that the owners qualify for a small miner waiver. The BLM has made the following findings:

1. Arizona Corporate Commission documents show that Big Bug Mining District LLC is a corporation registered in Arizona, dating back to 2017. According to Arizona Corporate Commission documents, the current statutory agent is Timothy Hayden. Listed as the current managing members are Dale C. Bennett, Owen Wildman, Gerald A. Baker, and Philip L. Condrey.
2. Big Bug Mining District LLC owns 10 mining claims in Arizona. The 2021 maintenance fees were paid on these claims. The claim numbers are AMC437424, AMC439458, AMC440507, AMC443155, AMC445640, AMC452459, AMC452460, AMC452461, AMC457154, AMC457155.
3. The current mailing address BLM has for Big Bug Mining District LLC is PO Box 1238, Mayer, AZ 86333-1238. This is the same address on file for Owen Wildman.
4. Ownership of the mining claims is shown on an enclosure.

In accordance with 43 C.F.R. 3835.92(d), because you or a co-claimant own more than 10 mining claims or sites and submitted a small miner waiver request and failed to pay the required maintenance fee on or before the due date for the 2021 assessment year, the mining claims listed above are declared forfeited and void as of September 1, 2020. Additionally you and the co-claimants may be subject to criminal penalties under 18 U.S.C. 1001.

Reclamation Requirements

This decision does not relieve you of the liability for reclamation of all areas disturbed by your activities on lands covered by the subject mining claim(s) and/or site(s). After you complete the reclamation, you must notify the authorized officer of the appropriate surface managing agency so that the authorized officer may conduct a final site inspection and determine whether you may be released from liability. If you fail to reclaim the land to the satisfaction of the authorized officer, the surface management agency may cite you for noncompliance under its surface management regulations.

For land administered by the BLM, if you fail to reclaim the land to the satisfaction of the authorized officer as required in 43 CFR Subpart 3809, the BLM will issue an order of noncompliance under 43 CFR 3809.601(a). If you fail to comply with the noncompliance

order, the BLM may take further action under 43 CFR 3809.604. Failure to conduct reclamation is a prohibited act that may subject you to criminal penalties. (See 43 CFR 3809.605(h) and 43 CFR 3809.700)

Appeal Procedures

This decision may be appealed to the Interior Board of Land Appeals (IBLA), Office of the Secretary, in accordance with the regulations contained in 43 CFR Part 4, and the enclosed Form 1842-1. If an appeal is taken, your notice of appeal must be filed in this office (at the above address) within 30 days from receipt of this decision. The appellant has the burden of showing that the decision appealed from is in error.

If you wish to file a petition pursuant to regulation 43 CFR 4.21 (58 FR 4939, January 19, 1993) for a stay of the effectiveness of this decision during the time that your appeal is being reviewed by the Board, the petition for a stay must accompany your notice of appeal. A petition for a stay is required to show sufficient justification based on the standards listed below. Copies of the notice of appeal and petition for a stay must also be submitted to each party named in this decision and to the IBLA and to the appropriate Office of the Solicitor (see 43 CFR 4.413) at the same time the original documents are filed with this office. If you request a stay, you have the burden of proof to demonstrate that a stay should be granted.

Standards for Obtaining a Stay

Except as otherwise provided by law or other pertinent regulation, a petition for a stay of a decision pending appeal shall show sufficient justification based on the following standards:

- (1) The relative harm to the parties if the stay is granted or denied,
- (2) The likelihood of the appellant's success on the merits,
- (3) The likelihood of immediate and irreparable harm if the stay is not granted, and
- (4) Whether the public interest favors granting the stay.

Please include your AMC serial number(s) on all correspondence. If additional information is required, please contact RéAnn Myers at 602-417-9413.

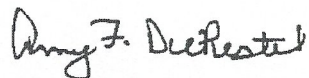

Amy F. DePestel
Supervisory Land Law Examiner
Lands, Minerals and Energy Division

Enclosures

Date Produced: 10/12/2020

ConnectSuite Inc.:

The following is the delivery information for Certified Mail™/RRE item number 9214 8901 9403 8321 8502 70. Our records indicate that this item was delivered on 10/06/2020 at 01:21 p.m. in HUMBOLDT, AZ 86329. The scanned image of the recipient information is provided below.

Signature of Recipient :



Address of Recipient :

PO BOX 684

HUMBOLDT, AZ 86329-0684

Thank you for selecting the Postal Service for your mailing needs. If you require additional assistance, please contact your local post office or Postal Service representative.

Sincerely,
United States Postal Service

The customer reference number shown below is not validated or endorsed by the United States Postal Service. It is solely for customer use.

Customer Reference Number: C2295416.13061758



United States Department of the Interior



BUREAU OF LAND MANAGEMENT
Arizona State Office
One North Central Avenue, Suite 800
Phoenix, Arizona 85004-4427
www.blm.gov/az/

SEP 30 2020

In Reply Refer To:

3800 (9200) RM

AMC390560, AMC390605, AMC395564, AMC414439, AMC425373, AMC429963,
AMC452238, AMC458030, AMC458210

CERTIFIED MAIL - RETURN RECEIPT REQUESTED 9214 8901 9403 8321 8502 87

DECISION

PATRICK C RUDOLPH
14005 E WAGON WHEEL DR
DEWEY, AZ 86327-6844

AMC390560, AMC390605, AMC395564, AMC414439, AMC425373, AMC429963,
AMC452238, AMC458030, AMC458210
PIANO MAN, SWINDLER NORTH, FORBACH PONDS BENCH, PIANO MAN 2,
LOADED FOR BEAR, CHAPARRAL GULCH, DOUBLE L, UNION 3, SILVER QUEEN

Maintenance Fee Waiver Certifications Denied Mining Claims Declared Forfeited

The Maintenance Fee Waiver Certifications (small miner waivers) filed for the 2021 assessment year, for the mining claims listed above, are denied. Because the small miner waivers are denied and because the required maintenance fee payments due on or before September 1, 2020, were not paid, these claims are declared forfeited.

The Bureau of Land Management's (BLM) regulations at 43 CFR 3830.21, and 3834.11(a)(2) state that by September 1 of each year, holders of mining claims must pay an annual maintenance fee of \$165 per claim per 20 acres or portion thereof. In lieu of paying the required maintenance fee, claimants may submit a valid small miner waiver, in accordance with 43 CFR 3835.1, 3835.10, and 3835.11.

In accordance with 43 CFR 3835.1(b), to qualify for a small miner waiver, you and all related parties must hold no more than a total of 10 mining claims or sites nationwide. As defined at

43 CFR 3830.5, "related party means: a) the spouse and dependent children of the claimant as defined in section 152 of the Internal Revenue Code of 1986 [26 U.S.C. section 152]; or, b) A person who controls, is controlled by, or is under common control with the claimant." "Control means actual control, legal control, or the power to exercise control, through or by common directors, officers, stockholders, a voting trust, or a holding company or Investment Company, or any other means."

Small miner waivers were filed for the seventeen mining claims listed above. The BLM has reviewed the case files for each of the mining claims listed above to verify that the owners qualify for a small miner waiver. The BLM has made the following findings:

1. Arizona Corporate Commission documents show that Big Bug Mining District LLC is a corporation registered in Arizona, dating back to 2017. According to Arizona Corporate Commission documents, the current statutory agent is Timothy Hayden. Listed as the current managing members are Dale C. Bennett, Owen Wildman, Gerald A. Baker, and Philip L. Condrey.
2. Big Bug Mining District LLC owns 10 mining claims in Arizona. The 2021 maintenance fees were paid on these claims. The claim numbers are AMC437424, AMC439458, AMC440507, AMC443155, AMC445640, AMC452459, AMC452460, AMC452461, AMC457154, AMC457155.
3. The current mailing address BLM has for Big Bug Mining District LLC is PO Box 1238, Mayer, AZ 86333-1238. This is the same address on file for Owen Wildman.
4. Ownership of the mining claims is shown on an enclosure.

In accordance with 43 C.F.R. 3835.92(d), because you or a co-claimant own more than 10 mining claims or sites and submitted a small miner waiver request and failed to pay the required maintenance fee on or before the due date for the 2021 assessment year, the mining claims listed above are declared forfeited and void as of September 1, 2020. Additionally you and the co-claimants may be subject to criminal penalties under 18 U.S.C. 1001.

Reclamation Requirements

This decision does not relieve you of the liability for reclamation of all areas disturbed by your activities on lands covered by the subject mining claim(s) and/or site(s). After you complete the reclamation, you must notify the authorized officer of the appropriate surface managing agency so that the authorized officer may conduct a final site inspection and determine whether you may be released from liability. If you fail to reclaim the land to the satisfaction of the authorized officer, the surface management agency may cite you for noncompliance under its surface management regulations.

For land administered by the BLM, if you fail to reclaim the land to the satisfaction of the authorized officer as required in 43 CFR Subpart 3809, the BLM will issue an order of noncompliance under 43 CFR 3809.601(a). If you fail to comply with the noncompliance

order, the BLM may take further action under 43 CFR 3809.604. Failure to conduct reclamation is a prohibited act that may subject you to criminal penalties. (See 43 CFR 3809.605(h) and 43 CFR 3809.700)

Appeal Procedures

This decision may be appealed to the Interior Board of Land Appeals (IBLA), Office of the Secretary, in accordance with the regulations contained in 43 CFR Part 4, and the enclosed Form 1842-1. If an appeal is taken, your notice of appeal must be filed in this office (at the above address) within 30 days from receipt of this decision. The appellant has the burden of showing that the decision appealed from is in error.

If you wish to file a petition pursuant to regulation 43 CFR 4.21 (58 FR 4939, January 19, 1993) for a stay of the effectiveness of this decision during the time that your appeal is being reviewed by the Board, the petition for a stay must accompany your notice of appeal. A petition for a stay is required to show sufficient justification based on the standards listed below. Copies of the notice of appeal and petition for a stay must also be submitted to each party named in this decision and to the IBLA and to the appropriate Office of the Solicitor (see 43 CFR 4.413) at the same time the original documents are filed with this office. If you request a stay, you have the burden of proof to demonstrate that a stay should be granted.

Standards for Obtaining a Stay

Except as otherwise provided by law or other pertinent regulation, a petition for a stay of a decision pending appeal shall show sufficient justification based on the following standards:

- (1) The relative harm to the parties if the stay is granted or denied,
- (2) The likelihood of the appellant's success on the merits,
- (3) The likelihood of immediate and irreparable harm if the stay is not granted, and
- (4) Whether the public interest favors granting the stay.

Please include your AMC serial number(s) on all correspondence. If additional information is required, please contact RéAnn Myers at 602-417-9413.

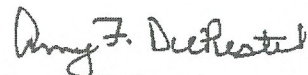

Amy F. DePestel
Supervisory Land Law Examiner
Lands, Minerals and Energy Division

Enclosures

Date Produced: 10/12/2020

ConnectSuite Inc.:

The following is the delivery information for Certified Mail™/RRE item number 9214 8901 9403 8321 8502 87. Our records indicate that this item was delivered on 10/06/2020 at 11:23 a.m. in DEWEY, AZ 86327. The scanned image of the recipient information is provided below.

Signature of Recipient :

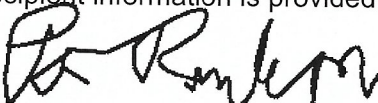
Post Robin

Address of Recipient :

17005 E. Wagon
WINDYBUSH AZ 86327

Thank you for selecting the Postal Service for your mailing needs. If you require additional assistance, please contact your local post office or Postal Service representative.

Sincerely,
United States Postal Service

The customer reference number shown below is not validated or endorsed by the United States Postal Service. It is solely for customer use.

Customer Reference Number: C2295416.13061759



United States Department of the Interior

BUREAU OF LAND MANAGEMENT
Arizona State Office
One North Central Avenue, Suite 800
Phoenix, Arizona 85004-4427
www.blm.gov/az/



SEP 30 2020

In Reply Refer To:

3800 (9200) RM

AMC390560, AMC390605, AMC395564, AMC414439, AMC425373, AMC429963,
AMC452238, AMC458030, AMC458210

CERTIFIED MAIL - RETURN RECEIPT REQUESTED 9214 8901 9403 8321 8502 94

DECISION

JOE AND JENNIFER OSUNA
12785 STOCKMENS
FLAGSTAFF, AZ 86004-9108

AMC390560, AMC390605, AMC395564, AMC414439, AMC425373, AMC429963,
AMC452238, AMC458030, AMC458210
PIANO MAN, SWINDLER NORTH, FORBACH PONDS BENCH, PIANO MAN 2,
LOADED FOR BEAR, CHAPARRAL GULCH, DOUBLE L, UNION 3, SILVER QUEEN

Maintenance Fee Waiver Certifications Denied Mining Claims Declared Forfeited

The Maintenance Fee Waiver Certifications (small miner waivers) filed for the 2021 assessment year, for the mining claims listed above, are denied. Because the small miner waivers are denied and because the required maintenance fee payments due on or before September 1, 2020, were not paid, these claims are declared forfeited.

The Bureau of Land Management's (BLM) regulations at 43 CFR 3830.21, and 3834.11(a)(2) state that by September 1 of each year, holders of mining claims must pay an annual maintenance fee of \$165 per claim per 20 acres or portion thereof. In lieu of paying the required maintenance fee, claimants may submit a valid small miner waiver, in accordance with 43 CFR 3835.1, 3835.10, and 3835.11.

In accordance with 43 CFR 3835.1(b), to qualify for a small miner waiver, you and all related parties must hold no more than a total of 10 mining claims or sites nationwide. As defined at

43 CFR 3830.5, "related party means: a) the spouse and dependent children of the claimant as defined in section 152 of the Internal Revenue Code of 1986 [26 U.S.C. section 152]; or, b) A person who controls, is controlled by, or is under common control with the claimant." "Control means actual control, legal control, or the power to exercise control, through or by common directors, officers, stockholders, a voting trust, or a holding company or Investment Company, or any other means."

Small miner waivers were filed for the seventeen mining claims listed above. The BLM has reviewed the case files for each of the mining claims listed above to verify that the owners qualify for a small miner waiver. The BLM has made the following findings:

1. Arizona Corporate Commission documents show that Big Bug Mining District LLC is a corporation registered in Arizona, dating back to 2017. According to Arizona Corporate Commission documents, the current statutory agent is Timothy Hayden. Listed as the current managing members are Dale C. Bennett, Owen Wildman, Gerald A. Baker, and Philip L. Condrey.
2. Big Bug Mining District LLC owns 10 mining claims in Arizona. The 2021 maintenance fees were paid on these claims. The claim numbers are AMC437424, AMC439458, AMC440507, AMC443155, AMC445640, AMC452459, AMC452460, AMC452461, AMC457154, AMC457155.
3. The current mailing address BLM has for Big Bug Mining District LLC is PO Box 1238, Mayer, AZ 86333-1238. This is the same address on file for Owen Wildman.
4. Ownership of the mining claims is shown on an enclosure.

In accordance with 43 C.F.R. 3835.92(d), because you or a co-claimant own more than 10 mining claims or sites and submitted a small miner waiver request and failed to pay the required maintenance fee on or before the due date for the 2021 assessment year, the mining claims listed above are declared forfeited and void as of September 1, 2020. Additionally you and the co-claimants may be subject to criminal penalties under 18 U.S.C. 1001.

Reclamation Requirements

This decision does not relieve you of the liability for reclamation of all areas disturbed by your activities on lands covered by the subject mining claim(s) and/or site(s). After you complete the reclamation, you must notify the authorized officer of the appropriate surface managing agency so that the authorized officer may conduct a final site inspection and determine whether you may be released from liability. If you fail to reclaim the land to the satisfaction of the authorized officer, the surface management agency may cite you for noncompliance under its surface management regulations.

For land administered by the BLM, if you fail to reclaim the land to the satisfaction of the authorized officer as required in 43 CFR Subpart 3809, the BLM will issue an order of noncompliance under 43 CFR 3809.601(a). If you fail to comply with the noncompliance

order, the BLM may take further action under 43 CFR 3809.604. Failure to conduct reclamation is a prohibited act that may subject you to criminal penalties. (See 43 CFR 3809.605(h) and 43 CFR 3809.700)

Appeal Procedures

This decision may be appealed to the Interior Board of Land Appeals (IBLA), Office of the Secretary, in accordance with the regulations contained in 43 CFR Part 4, and the enclosed Form 1842-1. If an appeal is taken, your notice of appeal must be filed in this office (at the above address) within 30 days from receipt of this decision. The appellant has the burden of showing that the decision appealed from is in error.

If you wish to file a petition pursuant to regulation 43 CFR 4.21 (58 FR 4939, January 19, 1993) for a stay of the effectiveness of this decision during the time that your appeal is being reviewed by the Board, the petition for a stay must accompany your notice of appeal. A petition for a stay is required to show sufficient justification based on the standards listed below. Copies of the notice of appeal and petition for a stay must also be submitted to each party named in this decision and to the IBLA and to the appropriate Office of the Solicitor (see 43 CFR 4.413) at the same time the original documents are filed with this office. If you request a stay, you have the burden of proof to demonstrate that a stay should be granted.

Standards for Obtaining a Stay

Except as otherwise provided by law or other pertinent regulation, a petition for a stay of a decision pending appeal shall show sufficient justification based on the following standards:

- (1) The relative harm to the parties if the stay is granted or denied,
- (2) The likelihood of the appellant's success on the merits,
- (3) The likelihood of immediate and irreparable harm if the stay is not granted, and
- (4) Whether the public interest favors granting the stay.

Please include your AMC serial number(s) on all correspondence. If additional information is required, please contact RéAnn Myers at 602-417-9413.

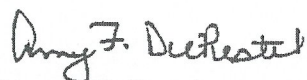

Amy F. DePestel
Supervisory Land Law Examiner
Lands, Minerals and Energy Division

Enclosures

Date Produced: 10/12/2020

ConnectSuite Inc.:

The following is the delivery information for Certified Mail™/RRE item number 9214 8901 9403 8321 8502 94. Our records indicate that this item was delivered on 10/06/2020 at 01:44 p.m. in FLAGSTAFF, AZ 86004. The scanned image of the recipient information is provided below.

Signature of Recipient :

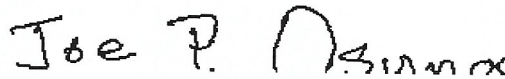

Address of Recipient :

12785 STOCKMEN
FLAGSTAFF, AZ 86004-9108

Thank you for selecting the Postal Service for your mailing needs. If you require additional assistance, please contact your local post office or Postal Service representative.

Sincerely,
United States Postal Service

The customer reference number shown below is not validated or endorsed by the United States Postal Service. It is solely for customer use.

Customer Reference Number: C2295416.13061760



United States Department of the Interior



BUREAU OF LAND MANAGEMENT

Arizona State Office

One North Central Avenue, Suite 800

Phoenix, Arizona 85004-4427

www.blm.gov/az/

SEP 30 2020

In Reply Refer To:

3800 (9200) RM

AMC390560, AMC390605, AMC395564, AMC414439, AMC425373, AMC429963,
AMC452238, AMC458030, AMC458210

CERTIFIED MAIL - RETURN RECEIPT REQUESTED 9214 8901 9403 8321 8503 00

DECISION

WARREN SMITH
6060 E NUGGET PATCH TRL
PRESCOTT, AZ 86303-6273

AMC390560, AMC390605, AMC395564, AMC414439, AMC425373, AMC429963,
AMC452238, AMC458030, AMC458210
PIANO MAN, SWINDLER NORTH, FORBACH PONDS BENCH, PIANO MAN 2,
LOADED FOR BEAR, CHAPARRAL GULCH, DOUBLE L, UNION 3, SILVER QUEEN

Maintenance Fee Waiver Certifications Denied Mining Claims Declared Forfeited

The Maintenance Fee Waiver Certifications (small miner waivers) filed for the 2021 assessment year, for the mining claims listed above, are denied. Because the small miner waivers are denied and because the required maintenance fee payments due on or before September 1, 2020, were not paid, these claims are declared forfeited.

The Bureau of Land Management's (BLM) regulations at 43 CFR 3830.21, and 3834.11(a)(2) state that by September 1 of each year, holders of mining claims must pay an annual maintenance fee of \$165 per claim per 20 acres or portion thereof. In lieu of paying the required maintenance fee, claimants may submit a valid small miner waiver, in accordance with 43 CFR 3835.1, 3835.10, and 3835.11.

In accordance with 43 CFR 3835.1(b), to qualify for a small miner waiver, you and all related parties must hold no more than a total of 10 mining claims or sites nationwide. As defined at

43 CFR 3830.5, "related party means: a) the spouse and dependent children of the claimant as defined in section 152 of the Internal Revenue Code of 1986 [26 U.S.C. section 152]; or, b) A person who controls, is controlled by, or is under common control with the claimant." "Control means actual control, legal control, or the power to exercise control, through or by common directors, officers, stockholders, a voting trust, or a holding company or Investment Company, or any other means."

Small miner waivers were filed for the seventeen mining claims listed above. The BLM has reviewed the case files for each of the mining claims listed above to verify that the owners qualify for a small miner waiver. The BLM has made the following findings:

1. Arizona Corporate Commission documents show that Big Bug Mining District LLC is a corporation registered in Arizona, dating back to 2017. According to Arizona Corporate Commission documents, the current statutory agent is Timothy Hayden. Listed as the current managing members are Dale C. Bennett, Owen Wildman, Gerald A. Baker, and Philip L. Condrey.
2. Big Bug Mining District LLC owns 10 mining claims in Arizona. The 2021 maintenance fees were paid on these claims. The claim numbers are AMC437424, AMC439458, AMC440507, AMC443155, AMC445640, AMC452459, AMC452460, AMC452461, AMC457154, AMC457155.
3. The current mailing address BLM has for Big Bug Mining District LLC is PO Box 1238, Mayer, AZ 86333-1238. This is the same address on file for Owen Wildman.
4. Ownership of the mining claims is shown on an enclosure.

In accordance with 43 C.F.R. 3835.92(d), because you or a co-claimant own more than 10 mining claims or sites and submitted a small miner waiver request and failed to pay the required maintenance fee on or before the due date for the 2021 assessment year, the mining claims listed above are declared forfeited and void as of September 1, 2020. Additionally you and the co-claimants may be subject to criminal penalties under 18 U.S.C. 1001.

Reclamation Requirements

This decision does not relieve you of the liability for reclamation of all areas disturbed by your activities on lands covered by the subject mining claim(s) and/or site(s). After you complete the reclamation, you must notify the authorized officer of the appropriate surface managing agency so that the authorized officer may conduct a final site inspection and determine whether you may be released from liability. If you fail to reclaim the land to the satisfaction of the authorized officer, the surface management agency may cite you for noncompliance under its surface management regulations.

For land administered by the BLM, if you fail to reclaim the land to the satisfaction of the authorized officer as required in 43 CFR Subpart 3809, the BLM will issue an order of noncompliance under 43 CFR 3809.601(a). If you fail to comply with the noncompliance

order, the BLM may take further action under 43 CFR 3809.604. Failure to conduct reclamation is a prohibited act that may subject you to criminal penalties. (See 43 CFR 3809.605(h) and 43 CFR 3809.700)

Appeal Procedures

This decision may be appealed to the Interior Board of Land Appeals (IBLA), Office of the Secretary, in accordance with the regulations contained in 43 CFR Part 4, and the enclosed Form 1842-1. If an appeal is taken, your notice of appeal must be filed in this office (at the above address) within 30 days from receipt of this decision. The appellant has the burden of showing that the decision appealed from is in error.

If you wish to file a petition pursuant to regulation 43 CFR 4.21 (58 FR 4939, January 19, 1993) for a stay of the effectiveness of this decision during the time that your appeal is being reviewed by the Board, the petition for a stay must accompany your notice of appeal. A petition for a stay is required to show sufficient justification based on the standards listed below. Copies of the notice of appeal and petition for a stay must also be submitted to each party named in this decision and to the IBLA and to the appropriate Office of the Solicitor (see 43 CFR 4.413) at the same time the original documents are filed with this office. If you request a stay, you have the burden of proof to demonstrate that a stay should be granted.

Standards for Obtaining a Stay

Except as otherwise provided by law or other pertinent regulation, a petition for a stay of a decision pending appeal shall show sufficient justification based on the following standards:

- (1) The relative harm to the parties if the stay is granted or denied,
- (2) The likelihood of the appellant's success on the merits,
- (3) The likelihood of immediate and irreparable harm if the stay is not granted, and
- (4) Whether the public interest favors granting the stay.

Please include your AMC serial number(s) on all correspondence. If additional information is required, please contact RéAnn Myers at 602-417-9413.

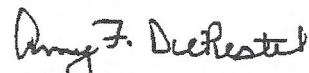

Amy F. DePestel
Supervisory Land Law Examiner
Lands, Minerals and Energy Division

Enclosures



Date Produced: 10/12/2020

ConnectSuite Inc.:

The following is the delivery information for Certified Mail™/RRE item number 9214 8901 9403 8321 8503 00. Our records indicate that this item was delivered on 10/05/2020 at 04:38 p.m. in PRESCOTT, AZ 86303. The scanned image of the recipient information is provided below.

Signature of Recipient :

Address of Recipient :

Thank you for selecting the Postal Service for your mailing needs. If you require additional assistance, please contact your local post office or Postal Service representative.

Sincerely,
United States Postal Service

The customer reference number shown below is not validated or endorsed by the United States Postal Service. It is solely for customer use.

Customer Reference Number: C2295416.13061761

U.S. Postal Service™

CERTIFIED MAIL™ RECEIPT

(Domestic Mail Only; No Insurance Coverage Provided)

For delivery information visit our website at www.usps.com®

OFFICIAL MAIL

Postage

\$

Certified Fee

Return Receipt Fee
(Endorsement Required)

Restricted Delivery Fee
(Endorsement Required)

Total

PATRICK C RUDOLPH

Sent

14005 E WAGON WHEEL DR

Street
or PO

DEWEY AZ 86327-6844

City

9310/RM/AMC429963

Postmark
Here

2015 MAY 13 P 2:33

ANZONIA

2014 0150 0000 5455 0000 0510 0510 4102

Certified Mail Provides:

- A mailing receipt
- A unique identifier for your mailpiece
- A record of delivery kept by the Postal Service for two years

Important Reminders:

- Certified Mail may **ONLY** be combined with First-Class Mail[®] or Priority Mail[®].
- Certified Mail is *not* available for any class of international mail.
- **NO INSURANCE COVERAGE IS PROVIDED** with Certified Mail. For valuables, please consider Insured or Registered Mail.
- For an additional fee, a *Return Receipt* may be requested to provide proof of delivery. To obtain Return Receipt service, please complete and attach a Return Receipt (PS Form 3811) to the article and add applicable postage to cover the fee. Endorse mailpiece "Return Receipt Requested". To receive a fee waiver for a duplicate return receipt, a USPS[®] postmark on your Certified Mail receipt is required.
- For an additional fee, delivery may be restricted to the addressee or addressee's authorized agent. Advise the clerk or mark the mailpiece with the endorsement "*Restricted Delivery*".
- If a postmark on the Certified Mail receipt is desired, please present the article at the post office for postmarking. If a postmark on the Certified Mail receipt is not needed, detach and affix label with postage and mail.

IMPORTANT: Save this receipt and present it when making an inquiry.

SENDER: COMPLETE THIS SECTION

- Complete items 1, 2, and 3. Also complete item 4 if Restricted Delivery is desired.
- Print your name and address on the reverse so that we can return the card to you.
- Attach this card to the back of the mailpiece, or on the front if space permits.

1. Article Addressed to:

PATRICK C RUDOLPH
 14005 E WAGON WHEEL DR
 DEWEY AZ 86327-6844
 9310/RM/AMC429963

2. Article Number

(Transfer from service label)

7014 0150 0000 5453 6902

COMPLETE THIS SECTION ON DELIVERY

A. Signature

Patrick C Rudolph
 Agent
 Addressee

B. Received by (Printed Name)

Patrick C Rudolph

C. Date of Delivery

5/18/15

D. Is delivery address different from item 1? YesIf YES, enter delivery address below: No

2015 MAY 19 P 2 58

3. Service Type

- Certified Mail® Priority Mail Express™
- Registered Return Receipt for Merchandise
- Insured Mail Collect on Delivery

4. Restricted Delivery? (Extra Fee)

 Yes

UNITED STATES POSTAL SERVICE



First-Class Mail
Postage & Fees Paid
USPS
Permit No. G-10

- Sender: Please print your name, address, and ZIP+4® in this box•

U.S. DEPARTMENT OF THE INTERIOR
BUREAU OF LAND MANAGEMENT
ARIZONA STATE OFFICE
ONE NORTH CENTRAL AVENUE, SUITE 800
PHOENIX, AZ 85004-4427



United States Department of the Interior

BUREAU OF LAND MANAGEMENT
Arizona State Office
One North Central Avenue, Suite 800
Phoenix, Arizona 85004-4427
www.blm.gov/az/



MAY 13 2015

In Reply Refer To:
3800 (9310) RM
AMC429963

CERTIFIED MAIL - RETURN RECEIPT REQUESTED No. 7014 0150 0000 5453 6902

NOTICE

PATRICK C RUDOLPH	:	This Notice Affects the Claims
14005 E WAGON WHEEL DR	:	Shown in the Block Below.
DEWEY, AZ 86327-6844	:	

AMC429963
CHAPARRAL GULCH

Mining Claim Location Notice – Amendment Required

Pursuant to Title 43 Code of Federal Regulations (CFR) 3832.1, this office received your notices of location for recording mining claims. In accordance with 43 CFR 3832.12, the claims listed above cannot be accepted as filed and must be amended as noted below.

1. Your claim contains excess acreage. A placer claim located by one locator can only contain 20 acres. Your claim dimensions are 1500 x 600, which equals 20.66 acres. You must file an amendment to reduce your claim to 20 acres. Please be aware that 1500 x 600 are the dimensions for a Lode mining claim. If you mistakenly filed a Placer claim rather than a Lode claim, you should relinquish this claim and relocate it correctly. You cannot change the type of claim from a Placer to a Lode with an amendment. If you amend your claim, be aware that you cannot take in new ground with an amendment. Therefore, the width of the claim would have to remain 600 feet and the length would need to be reduced to at least 1320 feet.
2. The placer mining claim listed above is located diagonally and does not conform to the U.S. Public Land Survey System and its rectangular subdivisions, as required.

In accordance with 43 CFR 3832.12(c) (1) You must describe placer claims by aliquot part and complete lots using the U.S. Public Land Survey System and its rectangular subdivisions except when placer claims are (i) on unsurveyed Federal lands; (ii) Gulch or bench placer claims; or (iii) Bounded by other mining claims or nonmineral lands. If one of these situations exists you

must describe the lands by protracted survey or by metes and bounds. The amendment must provide one of the following:

- a) Identify which situation exists to allow a placer to be located by metes and bounds and provide a metes and bounds description; or
- b) Locate the mining claim using the U.S. Public Land Survey System and its rectangular subdivisions and describe the mining claim by aliquot parts and complete lots.

If the claim is to be described by aliquot parts and complete lots, it may result in a claim that contains significantly less acreage than was originally located. If you wish to retain the same acreage, you may want to relocate the claim correctly, rather than amend the incorrectly located claim.

There is a \$10 Bureau of Land Management processing fee for each amendment. We must receive the amendments within 30 days of your receipt of this notice. If the amendments are not received within the 30-day timeframe the mining claims will be declared null and void.

If additional information is required, please contact RéAnn Myers at 602-417-9413. Please include your AMC serial number(s) on all correspondence.

Sincerely,

Michael J Werner
for

Rebecca Heick
Acting Deputy State Director
Lands and Minerals Division

U.S. Postal Service™

CERTIFIED MAIL™ RECEIPT

(Domestic Mail Only; No Insurance Coverage Provided)

For delivery information visit our website at www.usps.com®

OFFICIAL USE

Postage

\$ 0.00

Certified Fee

\$ 2.80

Return Receipt Fee
(Endorsement Required)

\$ 0.00

Restricted Delivery Fee
(Endorsement Required)

\$ 0.00

Total Postage & Fees

\$ 2.80

2015 MAY 13 P 2 34

Postmark
Here

PHILLIP CONDREY

PHILLIP CONDREY

PO BOX 684

HUMBOLDT AZ 86329-0684

9310/RM/AMC429963

Sent To

Street, #
or PO B

City, St

PS Form

actions

7014 0150 0000 5453 6896

Certified Mail Provides:

- A mailing receipt
- A unique identifier for your mailpiece
- A record of delivery kept by the Postal Service for two years

Important Reminders:

- Certified Mail may **ONLY** be combined with First-Class Mail® or Priority Mail®.
- Certified Mail is *not* available for any class of international mail.
- **NO INSURANCE COVERAGE IS PROVIDED** with Certified Mail. For valuables, please consider Insured or Registered Mail.
- For an additional fee, a *Return Receipt* may be requested to provide proof of delivery. To obtain Return Receipt service, please complete and attach a Return Receipt (PS Form 3811) to the article and add applicable postage to cover the fee. Endorse mailpiece "Return Receipt Requested". To receive a fee waiver for a duplicate return receipt, a USPS® postmark on your Certified Mail receipt is required.
- For an additional fee, delivery may be restricted to the addressee or addressee's authorized agent. Advise the clerk or mark the mailpiece with the endorsement "*Restricted Delivery*".
- If a postmark on the Certified Mail receipt is desired, please present the article at the post office for postmarking. If a postmark on the Certified Mail receipt is not needed, detach and affix label with postage and mail.

IMPORTANT: Save this receipt and present it when making an inquiry.

SENDER: COMPLETE THIS SECTION

- Complete items 1, 2, and 3. Also complete item 4 if Restricted Delivery is desired.
- Print your name and address on the reverse that we can return the card to you.
- Attach this card to the back of the mailpiece, or on the front if space permits.

1. Article Addressed to:

PHILLIP CONDREY
 PO BOX 684
 HUMBOLDT AZ 86329-0684
 9310/RM/AMC429963

2. Article Number

(Transfer from service label)

7014 0150 0000 5453 6896

COMPLETE THIS SECTION ON DELIVERY

A. Signature

X

Phillip Condrey

 Agent Addressee

B. Received by (Printed Name)

Phillip Condrey

C. Date of Delivery

5-18-2015

D. Is delivery address different from item 1?

 Yes

If YES, enter delivery address below:

 No

2015 MAY 20

P 2:51

MAY 18 2015

3. Service Type

 Certified Mail® Priority Mail Express™ Registered Return Receipt for Merchandise Insured Mail Collect on Delivery

4. Restricted Delivery? (Extra Fee)

 Yes

UNITED STATES POSTAL SERVICE

AZ 852

18 MAY '15

PM 1 1



First-Class Mail
Postage & Fees Paid
USPS
Permit No. G-10

- Sender: Please print your name, address, and ZIP+4® in this box•

U.S. DEPARTMENT OF THE INTERIOR
BUREAU OF LAND MANAGEMENT
ARIZONA STATE OFFICE
ONE NORTH CENTRAL AVENUE, SUITE 800
PHOENIX, AZ 85004-4427

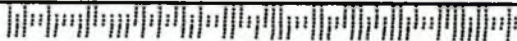



United States Department of the Interior



BUREAU OF LAND MANAGEMENT
Arizona State Office
One North Central Avenue, Suite 800
Phoenix, Arizona 85004-4427
www.blm.gov/az

MAY 13 2015

In Reply Refer To:
3800 (9310) RM
AMC429963

CERTIFIED MAIL - RETURN RECEIPT REQUESTED No. 7014 0150 0000 5453 6896

NOTICE

PHILLIP CONDREY : This Notice Affects the Claims
PO BOX 684 : Shown in the Block Below.
HUMBOLDT, AZ 86329-0684 :

AMC429963
CHAPARRAL GULCH

Mining Claim Location Notice – Amendment Required

Pursuant to Title 43 Code of Federal Regulations (CFR) 3832.1, this office received your notices of location for recording mining claims. In accordance with 43 CFR 3832.12, the claims listed above cannot be accepted as filed and must be amended as noted below.

1. Your claim contains excess acreage. A placer claim located by one locator can only contain 20 acres. Your claim dimensions are 1500 x 600, which equals 20.66 acres. You must file an amendment to reduce your claim to 20 acres. Please be aware that 1500 x 600 are the dimensions for a Lode mining claim. If you mistakenly filed a Placer claim rather than a Lode claim, you should relinquish this claim and relocate it correctly. You cannot change the type of claim from a Placer to a Lode with an amendment. If you amend your claim, be aware that you cannot take in new ground with an amendment. Therefore, the width of the claim would have to remain 600 feet and the length would need to be reduced to at least 1320 feet.
2. The placer mining claim listed above is located diagonally and does not conform to the U.S. Public Land Survey System and its rectangular subdivisions, as required.

In accordance with 43 CFR 3832.12(c) (1) You must describe placer claims by aliquot part and complete lots using the U.S. Public Land Survey System and its rectangular subdivisions except when placer claims are (i) on unsurveyed Federal lands; (ii) Gulch or bench placer claims; or (iii) Bounded by other mining claims or nonmineral lands. If one of these situations exists you

must describe the lands by protracted survey or by metes and bounds. The amendment must provide one of the following:

- a) Identify which situation exists to allow a placer to be located by metes and bounds and provide a metes and bounds description; or
- b) Locate the mining claim using the U.S. Public Land Survey System and its rectangular subdivisions and describe the mining claim by aliquot parts and complete lots.

If the claim is to be described by aliquot parts and complete lots, it may result in a claim that contains significantly less acreage than was originally located. If you wish to retain the same acreage, you may want to relocate the claim correctly, rather than amend the incorrectly located claim.

There is a \$10 Bureau of Land Management processing fee for each amendment. We must receive the amendments within 30 days of your receipt of this notice. If the amendments are not received within the 30-day timeframe the mining claims will be declared null and void.

If additional information is required, please contact RéAnn Myers at 602-417-9413. Please include your AMC serial number(s) on all correspondence.

Sincerely,

Michael J Werner
for

Rebecca Heick
Acting Deputy State Director
Lands and Minerals Division

NOTICE!!

These documents have been scanned!

Do not place un-scanned documents beneath this notice!

Do not remove this notice from this file!

GPO Jacket No. 560-102
Print Order 61540
Rise Business Services, LLC
Job=AZ15 5/10/2019



Box Number= AZ15031



Claim Begin-End: AMC429963-AMC429963

3 Transfers



AZ15031-24

AMC429540-AMC429995

**NO
DOCUMENTS
FOUND**

NO DOCUMENTS FOUND
NO DOCUMENTS FOUND

NOTICE!!

These documents have been scanned!

Do not place un-scanned documents beneath this notice!

Do not remove this notice from this file!

GPO Jacket No. 560-102
Print Order 61540
Rise Business Services, LLC
Job=AZ15 5/10/2019



Box Number= AZ15031



Claim Begin-End: AMC429963-AMC429963

4 Annual Filings



AZ15031-24

AMC429540-AMC429995

UNITED STATES
DEPARTMENT OF THE INTERIOR
BUREAU OF LAND MANAGEMENT

MAINTENANCE FEE WAIVER CERTIFICATION

SEE INSTRUCTIONS ON PAGE 2

356 JMK

429963
390605

FORM APPROVED
OMB NO. 1004-0114
Expires: April 30, 2023
395564

- This small miner waiver is filed for the assessment year beginning on September 1, 2020 and ending on September 1, 2021. 458210
- The undersigned and all related parties owned ten or fewer mining claims, mill, or tunnel sites located and maintained on Federal lands in the United States of America on September 1, 2020.
- The undersigned have performed the assessment work required by law for each mining claim listed prior to filing this waiver and understand that by filing this form, the undersigned must file an affidavit of assessment work with the Bureau of Land Management (BLM) by the December 30th following the filing of this waiver.
- The undersigned understand that if the assessment work obligation has not yet come due under 30 U.S.C. 28 (for those claims in their first assessment year only), a notice of intent to hold reciting this condition must be recorded by the December 30th following the filing of this waiver.
- The undersigned understand that mill and tunnel sites may also be listed on this waiver and be waived from payment of the maintenance fee, and that a notice of intent to hold for these sites is required to be filed with the BLM by the December 30th following the filing of this waiver.
- The undersigned understand and acknowledge that pursuant to 43 U.S.C. 1212 and 18 U.S.C. 1001, the filing or recording of a false, fictitious, or fraudulent document with the BLM may result in a fine of up to \$250,000, a prison term not to exceed five years, or both.
- The mining claims, mill or tunnel sites for which this waiver from payment of the maintenance fees is requested are:

CLAIM OR SITE NAME	BLM RECORDATION SERIAL NUMBER
1. Chaparral Gulch ✓	429963
2. Swindler North	390605
3. Forbach Ponds	395564
4. Silver Queen	458210
5.	
6.	
7.	
8.	
9.	
10.	

RECEIVED
BLM AZ STATE OFFICE
2020 AUG 24 A 8:28
PHOENIX, ARIZONA

The owner(s) (claimants) of the above mining claims and sites are:

Phillip L. Condrey
(Owner's Name - Please Print)
P.O. Box 684
(Owner's Mailing Address)

Phillip L. Condrey
(Owner's Original Signature)
Humboldt AZ 86329
(City) (State) (Zip Code)

Patrick C. Rudolph
(Owner's Name - Please Print)
14005 E. Wagon Wheel Dr.
(Owner's Mailing Address)

Patrick C. Rudolph
(Owner's Original Signature)
Dewey AZ 86327
(City) (State) (Zip Code)

Joseph P. Osuna
(Owner's Name - Please Print)
12785 Stockmens Rd.
(Owner's Mailing Address)

Joseph P. Osuna
(Owner's Original Signature)
Flagstaff AZ 86004
(City) (State) (Zip Code)

Jennifer J. Osuna
(Owner's Name - Please Print)
12785 Stockmens Rd.
(Owner's Mailing Address)

Jennifer J. Osuna
(Owner's Original Signature)
Flagstaff AZ 86004
(City) (State) (Zip Code)

4787500

390

PET

424954
429963

FORM APPROVED
OMB NO. 1004-0114
Expires: January 31, 2020
390605

MAINTENANCE FEE WAIVER CERTIFICATION

SEE INSTRUCTIONS ON PAGE 2

- This small miner waiver is filed for the assessment year beginning on September 1, 2018 and ending on September 1, 2019. 395564
- The undersigned and all related parties owned ten or fewer mining claims, mill, or tunnel sites located and maintained on Federal lands in the United States of America on September 1, 2018.
- The undersigned have performed the assessment work required by law for each mining claim listed prior to filing this waiver and understand that by filing this form, the undersigned must file an affidavit of assessment work with the Bureau of Land Management (BLM) by the December 30th following the filing of this waiver.
- The undersigned understand that if the assessment work obligation has not yet come due under 30 U.S.C. 28 (for those claims in their first assessment year only), a notice of intent to hold reciting this condition must be recorded by the December 30th following the filing of this waiver.
- The undersigned understand that mill and tunnel sites may also be listed on this waiver and be waived from payment of the maintenance fee, and that a notice of intent to hold for these sites is required to be filed with the BLM by the December 30th following the filing of this waiver.
- The undersigned understand and acknowledge that pursuant to 43 U.S.C. 1212 and 18 U.S.C. 1001, the filing or recording of a false, fictitious, or fraudulent document with the BLM may result in a fine of up to \$250,000, a prison term not to exceed five years, or both.
- The mining claims, mill or tunnel sites for which this waiver from payment of the maintenance fees is requested are:

CLAIM OR SITE NAME	BLM RECORDATION SERIAL NUMBER
1. Silver Queen	AMC 424954 (913)
2. Chaparral Gulch	AMC 424963
3. Swisshider North	AMC 390605
4. Peckback Ponds	AMC 395564
5.	
6.	
7.	
8.	
9.	
10.	

RECEIVED
BLM STATE OFFICE
PHOENIX, ARIZONA
AUG 28 A 10:32

The owner(s) (claimants) of the above mining claims and sites are:

Phillip L. Condrey
(Owner's Name - Please Print)
P.O. Box 634
(Owner's Mailing Address)

Phillip L. Condrey
(Owner's Signature)
Humboldt AZ 86329
(City) (State) (Zip Code)

Patrick C. Rudolph
(Owner's Name - Please Print)
14005 E. Wagon Wheel Dr.
(Owner's Mailing Address)

Patrick C. Rudolph
(Owner's Signature)
Dewey AZ 86327
(City) (State) (Zip Code)

Kevin Leonard
(Owner's Name - Please Print)
P.O. Box 943
(Owner's Mailing Address)

Kevin Leonard
(Owner's Signature)
Humboldt AZ 86329
(City) (State) (Zip Code)

Daniel A. Davis
(Owner's Name - Please Print)
1030 W. Loy Dr.
(Owner's Mailing Address)

Daniel Davis
(Owner's Signature)
Flagstaff AZ 86005
(City) (State) (Zip Code)

ENTERED
SEP 14 2018
BY: [Signature]

Rhonda A Davis
(Owner's Name - Please Print)

Rhonda A. Davis
(Owner's Signature)

1080 W. Coy Dr.
(Owner's Mailing Address)

Flagstaff AZ 86005
(City) (State) (Zip Code)

Joseph P. Osuna
(Owner's Name - Please Print)

Joseph P. Osuna
(Owner's Signature)

12725 Stockmens Rd.
(Owner's Mailing Address)

Flagstaff AZ 86004
(City) (State) (Zip Code)

Jennifer J. Osuna
(Owner's Name - Please Print)

Jennifer J. Osuna
(Owner's Signature)

12785 Stockmens Rd.
(Owner's Mailing Address)

Flagstaff AZ 86004
(City) (State) (Zip Code)

(Owner's Name - Please Print)

(Owner's Signature)

(Owner's Mailing Address)

(City)

(State)

(Zip Code)

18 U.S.C. 1001 and 43 U.S.C. 1212 make it a crime for any person knowingly and willfully to make to any department or agency of the United States any false, fictitious or fraudulent statements or representations as to any matter within its jurisdiction.

INSTRUCTIONS

1. This certification is made under the provisions of 43 U.S.C. § 1744 and 30 U.S.C. §28-28k and the regulations thereunder (43 CFR Part 3830).
2. The claimant(s) must fill in the dates in paragraph 1 for the beginning and ending of the assessment year for which this waiver is sought.
3. The claimant(s) must fill in the date in paragraph 2 for the beginning of the assessment year for which this waiver is sought.
4. All claim and site names and BLM serial numbers must be listed for the mining claims, mill sites, and tunnel sites for which the waiver is sought.
5. All owners of the mining claims, mill sites, and tunnel sites and their addresses must be given.
6. This waiver form must be signed by all the claimants or their designated agent, in original form. If an agent is designated, a notarized designation of agent, signed by all of the claimants with proper address given, must be submitted with this waiver.
7. This form must be filed no later than September 1st for the upcoming assessment year in the BLM State Office where the mining claims or sites are recorded, or the waiver cannot be granted by the BLM. (Example: To obtain a waiver for the assessment year 2012, which begins on September 1, 2011, you must qualify for and file for a waiver no later than September 1, 2011, in the proper BLM State Office.)
8. For all mining claims which require assessment work, you must record an affidavit of labor on or before the December 30th immediately following the filing of this waiver. For all other mining claims or sites waived, you must record a notice of intent to hold on or before the December 30th immediately following the filing of this waiver.
9. Mill and tunnel sites may also be listed on this waiver and be waived from payment of the maintenance fee. A notice of intent to hold for these sites is required to be filed by the December 30th following the filing of this waiver.

PHOENIX ARIZONA
2011 AUG 28 10:52
RECEIVED
STATE OFFICE

FOR OFFICIAL USE ONLY

When Recorded Return Document to:

Phillip L. Coakley
PO Box 594
Humboldt AZ 86329

424954
429963
390605
395564

Check here is this is a change of address.

Telephone: 928 273-0550

E-mail address: plcoakley@gmail.com

AFFIDAVIT OF PERFORMANCE OF ANNUAL WORK

1. State of Arizona, County of Yavapai ss:

2. I (Name) Phillip L. Coakley

3. Reside at (Address) 11625 E. Manning

Claim Trk.
City Humboldt County Yavapai

State AZ Zip 86329 being duly sworn, depose and say that I am a citizen of the United States, more than eighteen years of age, and that all of the facts set forth in this affidavit, subject to the provisions and penalties of 18 U.S.C. 1001 pertaining to the filing of false, fictitious, or fraudulent statements with the United States, are true and correct according to the best of my knowledge, information and belief.

4. Owner's name and address (If not shown in Items 1-3 above).

5. That I am personally acquainted with the mining claim(s). The work and improvements were made by and at the expense of the owner(s) of said claim(s). Said contiguous group of claims, listed on this document, are situated in the

(optional) Mining District: YAVAPAI County, Arizona.

Line No.	AMC NUMBER	CLAIM/SITE NAME	COUNTY RECORDER DATA (If available)	TWP	RNG	SEC
1	424954	Silver Queen		13N	1E	20
2	429963	Blackberry Grove		13N	1E	23
3	390605	Silver King North	F-4536 P-222	13N	1E	23
4	395564	Foreign Fords	F-4432 P-222	13N	4E	26
5						
6						

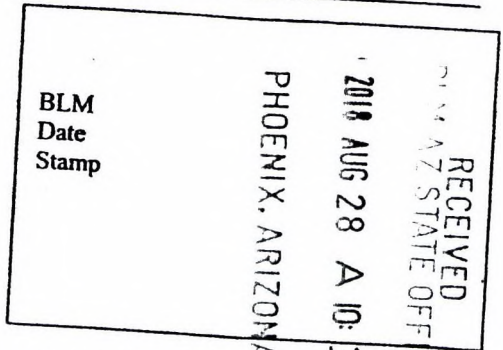

Form: MCF108
Revised July 2014
Page 1 of 2

ENTERED
AUG 29 2018
BY: RAM

RECEIVED
PHOENIX, ARIZONA
2018 AUG 28 A 10:32
BLM
Date
Stamp

7					
8					
9					
10					

6. That between the dates starting at 12 o'clock noon on September 1, 20 17 and ending at 12 o'clock noon on September 1, 20 18 at least \$ 1,000,000 dollars worth of work and improvements were done and performed upon said claim(s) or upon one or more of a contiguous group of claims for the benefit of all, wholly or partly outside of a contiguous group of claims for the benefit of all, not including the location work.

7. That the following persons were employed to perform the work and improvements described herein: Joe Gault, Edolph, Kevin Leonard, James Smith, and Mike

8. That the work and improvements performed were: Sampling, reclamation, water retriement, roadwork, access trails.

9. Dated: 8-24-18 Signature: Phillip L. Condrey

SUBSCRIBED AND SWORN TO before me, a Notary Public, this 24th day of August 20 18

By: Phillip L. Condrey
Notary Public Michael W. Robinson

My Commission Expires 4/1/2020

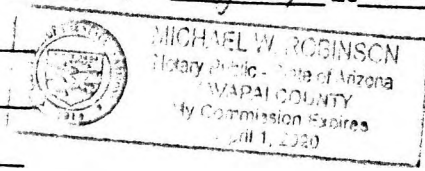

Bureau of Land Management
Arizona State Office
www.blm.gov/az

No. of Claims: 4 x \$10 = \$40,000
 Check No.: 1106 Init. PER
 Receipt No.: 4247291
 For BLM Use Only



Mr. Phillip L. Condrey
P.O. Box 684
Humboldt, AZ 86329-0684

Handwritten initials or mark, possibly "E: 99".

RECEIVED
STATE OFFICE
2018 AUG 28 A 10:32
PHOENIX, ARIZONA

United States Department of the Interior

Bureau of Land Management

DIV OF LANDS, MINRLS & ENERGY

ONE N CENTRAL AVE

PHOENIX, AZ 85004 -4427

Phone: 602-417-9200

Receipt

No:

4247291

Transaction #: 4362761	
Date of Transaction: 08/28/2018	
CUSTOMER:	
PHILLIP L CONDREY PO BOX 684 HUMBOLDT, AZ 86329-0684 US	

LINE #	QTY	DESCRIPTION	REMARKS	UNIT PRICE	TOTAL
1	1.00	LOCATABLE MINERALS / MINING CLAIMS-NOT NEW-UNADJUD, ONE AUTH NO. ONLY / MINING CLAIM MONEY RECEIVED CASES: AMC424954/\$40.00	2018 POL AND WAIVER/4	- n/a -	40.00
TOTAL:					\$40.00

PAYMENT INFORMATION			
1	AMOUNT:	40.00	POSTMARKED: N/A
	TYPE:	CHECK	RECEIVED: 08/28/2018
	CHECK NO:	1106	
	NAME:	CONDREY, PHILLIP L PO BOX 684 HUMBOLDT AZ 86329-0684 US	

REMARKS

This receipt was generated by the automated BLM Collections and Billing System and is a paper representation of a portion of the official electronic record contained therein.

When Recorded Return Document to:
Phillip L. Condrey
P.O. Box 684
11625 E. Mining Claim Trl.
Humboldt, AZ 86329-0684

424954
 429963
 390605
 395564

Check here if this is a change of address.

Telephone: 928 273-0550

E-mail address: plcondrey@gmail.com

AFFIDAVIT OF PERFORMANCE OF ANNUAL WORK

1. State of Arizona, County of Yavapai ss:
 2. I (Name) Phillip L. Condrey
 3. Reside at (Address) 11625 E. Mining Claim Trail (P.O. Box 684)
 City Humboldt County Yavapai

RECEIVED
 BLM
 Date Stamp
 2011 AUG 29 A 9:49
 PHOENIX, ARIZONA
 REGIONAL OFFICE

State AZ Zip 86329 being duly sworn, depose and say that I am a citizen of the United States, more than eighteen years of age, and that all of the facts set forth in this affidavit, subject to the provisions and penalties of 18 U.S.C. 1001 pertaining to the filing of false, fictitious, or fraudulent statements with the United States, are true and correct according to the best of my knowledge, information and belief.

4. Owner's name and address (If not shown in Items 1-3 above) _____

5. That I am personally acquainted with the mining claim(s). The work and improvements were made by and at the expense of the owner(s) of said claim(s). Said contiguous group of claims, listed on this document, are situated in the

(optional) Mining District; Yavapai County, Arizona.

Line No.	AMC NUMBER	CLAIM/SITE NAME	COUNTY RECORDER DATA (If available)	TWP	RNG	SEC
1	424954	Silver Queen		13N	1E	20
2	429963	Chaparral Gulch		13N 13N	1E 1W	30 35
3	390605	Swindler North	B.4576, P. 277	13N	1E	33
4	395564	Furbach Ponds	B.4632, P. 255	13N	4W	26
5						
6						

AUG 30 2017
 RAm

RECEIVED
 2017 AUG 29 A 9
 PHOENIX, ARIZONA
 BLM
 Date
 Stamp

7						
8						
9						
10						

6. That between the dates starting at 12 o'clock noon on September 1, 20 16 and ending at 12 o'clock noon on September 1, 20 17 at least \$ 800.00 dollars worth of work and improvements were done and performed upon said claim(s) or upon one or more of a contiguous group of claims for the benefit of all, wholly or partly outside of a contiguous group of claims for the benefit of all, not including the location work.

7. That the following persons were employed to perform the work and improvements described herein: Joe Osuna, Kevin Leonard, Patrick Rudolph, Warren Smith, and myself.

8. That the work and improvements performed were: Road work, access trails, water retainment, excavation and sampling.

9. Dated: 8-23-17 Signature: Phillip L. Condrey

SUBSCRIBED AND SWORN TO before me, a Notary Public, this 23 day of Aug 20 17

By: Phillip L. Condrey

Notary Public Eva M. Aiken

My Commission Expires 4-21-18

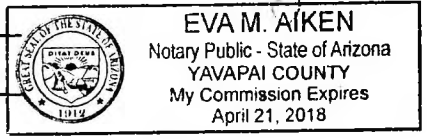

Bureau of Land Management
 Arizona State Office
www.az.blm.gov

No. of Claims: 4 x \$10 = 40.00
 Check No.: 1079 Init. PER
 Receipt No.: 3964303
 For BLM Use Only

United States Department of the Interior
Bureau of Land Management
 DIV OF LANDS, MINRLS & ENERGY
 ONE N CENTRAL AVE
 PHOENIX, AZ 85004 -4427
 Phone: 602-417-9200

Receipt

No: 3964303

Transaction #: 4074175	
Date of Transaction: 08/29/2017	
CUSTOMER:	
PHILLIP L CONDREY PO BOX 684 HUMBOLDT, AZ 86329-0684 US	

LINE #	QTY	DESCRIPTION	REMARKS	UNIT PRICE	TOTAL
1	1.00	LOCATABLE MINERALS / MINING CLAIMS-NOT NEW-UNADJUD, ONE AUTH NO. ONLY / MINING CLAIM MONEY RECEIVED CASES: AMC424954/\$40.00	AFFADAVIT/4 AND WAIVER	- n/a -	40.00
TOTAL:					\$40.00

PAYMENT INFORMATION			
1	AMOUNT:	40.00	POSTMARKED: N/A
	TYPE:	CHECK	RECEIVED: 08/29/2017
	CHECK NO:	1079	
	NAME:	CONDREY, PHILLIP L PO BOX 684 HUMBOLDT AZ 86329-0684 US	

REMARKS

This receipt was generated by the automated BLM Collections and Billing System and is a paper representation of a portion of the official electronic record contained therein.

UNITED STATES
DEPARTMENT OF THE INTERIOR
BUREAU OF LAND MANAGEMENT
MAINTENANCE FEE WAIVER CERTIFICATION

388

AMC 424954
429963
390605

FORM APPROVED 39556
OMB NO. 1004-0114
Expires: October 31, 2016

SEE INSTRUCTIONS ON PAGE 2

- This small miner waiver is filed for the assessment year beginning on September 1, 2017 and ending on September 1, 2018.
- The undersigned and all related parties owned ten or fewer mining claims, mill, or tunnel sites located and maintained on Federal lands in the United States of America on September 1, 2017.
- The undersigned have performed the assessment work required by law for each mining claim listed prior to filing this waiver and understand that by filing this form, the undersigned must file an affidavit of assessment work with the Bureau of Land Management (BLM) by the December 30th following the filing of this waiver.
- The undersigned understand that if the assessment work obligation has not yet come due under 30 U.S.C. 28 (for those claims in their first assessment year only), a notice of intent to hold reciting this condition must be recorded by the December 30th following the filing of this waiver.
- The undersigned understand that mill and tunnel sites may also be listed on this waiver and be waived from payment of the maintenance fee, and that a notice of intent to hold for these sites is required to be filed with the BLM by the December 30th following the filing of this waiver.
- The undersigned understand and acknowledge that pursuant to 43 U.S.C. 1212 and 18 U.S.C. 1001, the filing or recording of a false, fictitious, or fraudulent document with the BLM may result in a fine of up to \$250,000, a prison term not to exceed five years, or both.
- The mining claims, mill or tunnel sites for which this waiver from payment of the maintenance fees is requested are:

CLAIM OR SITE NAME	BLM RECORDATION SERIAL NUMBER
1. Silver Queen	AMC 424954
2. Chaparral Gulch	AMC 429963
3. Swindler North	AMC 390605
4. Forbach Ponds	AMC 395564
5.	
6.	
7.	
8.	
9.	
10.	

RECEIVED
 2017 AUG 29 A 9:49
 PHOENIX, ARIZONA
 OFFICE

The owner(s) (claimants) of the above mining claims and sites are:

Patrick Rudolph
(Owner's Name - Please Print)
14005 E. Wagon Wheel Dr.
(Owner's Mailing Address)

Patrick Rudolph
(Owner's Signature)
Dewey AZ 86377
(City) (State) (Zip Code)

Kevin Leonard
(Owner's Name - Please Print)
P.O. Box 943
(Owner's Mailing Address)

Kevin Leonard
(Owner's Signature)
Humboldt AZ 86329
(City) (State) (Zip Code)

Phillip L. Condrey
(Owner's Name - Please Print)
P.O. Box 684
(Owner's Mailing Address)

Phillip L. Condrey
(Owner's Signature)
Humboldt AZ 86329
(City) (State) (Zip Code)

Daniel A. Davis
(Owner's Name - Please Print)
1080 W. Coy Dr. 423
(Owner's Mailing Address)

Daniel Davis
(Owner's Signature)
Flagstaff AZ 86005
(City) (State) (Zip Code)

(Continued on page 2)

SEP 08 2017

BY: *M*

11

Rhonda A. Davis
(Owner's Name - Please Print)

1080 W. Coy Dr.
(Owner's Mailing Address)

Rhonda A. Davis
(Owner's Signature)

Flagstaff AZ 86005
(City) (State) (Zip Code)

Joseph P. Osuna
(Owner's Name - Please Print)

12785 Stockmens Rd.
(Owner's Mailing Address)

Joseph P. Osuna
(Owner's Signature)

Flagstaff AZ 86004
(City) (State) (Zip Code)

Jennifer J. Osuna
(Owner's Name - Please Print)

12785 Stockmens Rd.
(Owner's Mailing Address)

Jennifer J. Osuna
(Owner's Signature)

Flagstaff AZ 86004
(City) (State) (Zip Code)

WARREN K SMITH
(Owner's Name - Please Print)

10149 E. DURHAM RD
(Owner's Mailing Address)

Warren K Smith
(Owner's Signature)

DEWEY AZ 86327
(City) (State) (Zip Code)

18 U.S.C. 1001 and 43 U.S.C. 1212 make it a crime for any person knowingly and willfully to make to any department or agency of the United States any false, fictitious or fraudulent statements or representations as to any matter within its jurisdiction.

INSTRUCTIONS

1. This certification is made under the provisions of 43 U.S.C. § 1744 and 30 U.S.C. §28-28k and the regulations thereunder (43 CFR Part 3830).
2. The claimant(s) must fill in the dates in paragraph 1 for the beginning and ending of the assessment year for which this waiver is sought.
3. The claimant(s) must fill in the date in paragraph 2 for the beginning of the assessment year for which this waiver is sought.
4. All claim and site names and BLM serial numbers must be listed for the mining claims, mill sites, and tunnel sites for which the waiver is sought.
5. All owners of the mining claims, mill sites, and tunnel sites and their addresses must be given.
6. This waiver form must be signed by all the claimants or their designated agent, in original form. If an agent is designated, a notarized designation of agent, signed by all of the claimants with proper address given, must be submitted with this waiver.
7. This form must be filed no later than September 1st for the upcoming assessment year in the BLM State Office where the mining claims or sites are recorded, or the waiver cannot be granted by the BLM. (Example: To obtain a waiver for the assessment year 2012, which begins on September 1, 2011, you must qualify for and file for a waiver no later than September 1, 2011, in the proper BLM State Office.)
8. For all mining claims which require assessment work, you must record an affidavit of labor on or before the December 30th immediately following the filing of this waiver. For all other mining claims or sites waived, you must record a notice of intent to hold on or before the December 30th immediately following the filing of this waiver.
9. Mill and tunnel sites may also be listed on this waiver and be waived from payment of the maintenance fee. A notice of intent to hold for these sites is required to be filed by the December 30th following the filing of this waiver.

RECEIVED
STATE OFFICE
2011 AUG 29 A 9:49
TUCSON, ARIZONA

FOR OFFICIAL USE ONLY

UNITED STATES
DEPARTMENT OF THE INTERIOR
BUREAU OF LAND MANAGEMENT 529
MAINTENANCE FEE WAIVER CERTIFICATION

390605 424954
395564 429963

FORM APPROVED
OMB NO. 1004-0114
Expires: October 31, 2016

SEE INSTRUCTIONS ON PAGE 2

1. This small miner waiver is filed for the assessment year beginning on September 1, 2016 and ending on September 1, 2017.
2. The undersigned and all related parties owned ten or fewer mining claims, mill, or tunnel sites located and maintained on Federal lands in the United States of America on September 1, 2016.
3. The undersigned have performed the assessment work required by law for each mining claim listed prior to filing this waiver and understand that by filing this form, the undersigned must file an affidavit of assessment work with the Bureau of Land Management (BLM) by the December 30th following the filing of this waiver.
4. The undersigned understand that if the assessment work obligation has not yet come due under 30 U.S.C. 28 (for those claims in their first assessment year only), a notice of intent to hold reciting this condition must be recorded by the December 30th following the filing of this waiver.
5. The undersigned understand that mill and tunnel sites may also be listed on this waiver and be waived from payment of the maintenance fee, and that a notice of intent to hold for these sites is required to be filed with the BLM by the December 30th following the filing of this waiver.
6. The undersigned understand and acknowledge that pursuant to 43 U.S.C. 1212 and 18 U.S.C. 1001, the filing or recording of a false, fictitious, or fraudulent document with the BLM may result in a fine of up to \$250,000, a prison term not to exceed five years, or both.
7. The mining claims, mill or tunnel sites for which this waiver from payment of the maintenance fees is requested are:

CLAIM OR SITE NAME	BLM RECORDATION SERIAL NUMBER
1. Silver Queen	AMC 424954 ✓
2. Chaparral Gulch	AMC 429963
3. Swindler North	AMC 390605
4. Forbach Ponds	AMC 395564
5.	
6.	
7.	
8.	
9.	
10.	

RECEIVED
 BLM AT STATE OFFICE
 PHOENIX, ARIZONA
 2016 OCT 20 11:12

The owner(s) (claimants) of the above mining claims and sites are:

Patrick Rudolph
(Owner's Name - Please Print)
14005 E. Wagon Wheel Dr
(Owner's Mailing Address)

Patrick C. Rudolph
(Owner's Signature)
Dewey AZ 86327
(City) (State) (Zip Code)

Kevin Leonard
(Owner's Name - Please Print)
P.O. Box 943
(Owner's Mailing Address)

[Signature]
(Owner's Signature)
Humboldt AZ 86329
(City) (State) (Zip Code)

Phillip L. Condrey
(Owner's Name - Please Print)
P.O. Box 684
(Owner's Mailing Address)

Phillip L. Condrey
(Owner's Signature)
Humboldt AZ 86329
(City) (State) (Zip Code)

Daniel A. Davis
(Owner's Name - Please Print)
1080 W. Coy Dr
(Owner's Mailing Address)

[Signature]
(Owner's Signature)
Flagstaff AZ 86005
(City) (State) (Zip Code)

SEP 20 11 12 AM '16
NL
9-8
RE

Rhonda A. Davis
(Owner's Name - Please Print)

Rhonda A Davis
(Owner's Signature)

1080 W. Coy Dr
(Owner's/Mailing Address)

Flagstaff AZ 86005
(City) (State) (Zip Code)

Joseph P. Osuna
(Owner's Name - Please Print)

Joseph P. Osuna
(Owner's Signature)

12785 Stockmens Rd.
(Owner's Mailing Address)

Flagstaff AZ 86004
(City) (State) (Zip Code)

Jennifer J. Osuna
(Owner's Name - Please Print)

Jennifer J. Osuna
(Owner's Signature)

12785 Stockmens Rd.
(Owner's Mailing Address)

Flagstaff AZ 86004
(City) (State) (Zip Code)

(Owner's Name - Please Print)

(Owner's Signature)

(Owner's Mailing Address)

(City)

(State)

(Zip Code)

18 U.S.C. 1001 and 43 U.S.C. 1212 make it a crime for any person knowingly and willfully to make to any department or agency of the United States any false, fictitious or fraudulent statements or representations as to any matter within its jurisdiction.

INSTRUCTIONS

1. This certification is made under the provisions of 43 U.S.C. § 1744 and 30 U.S.C. §28-28k and the regulations thereunder (43 CFR Part 3830).
2. The claimant(s) must fill in the dates in paragraph 1 for the beginning and ending of the assessment year for which this waiver is sought.
3. The claimant(s) must fill in the date in paragraph 2 for the beginning of the assessment year for which this waiver is sought.
4. All claim and site names and BLM serial numbers must be listed for the mining claims, mill sites, and tunnel sites for which the waiver is sought.
5. All owners of the mining claims, mill sites, and tunnel sites and their addresses must be given.
6. This waiver form must be signed by all the claimants or their designated agent, in original form. If an agent is designated, a notarized designation of agent, signed by all of the claimants with proper address given, must be submitted with this waiver.
7. This form must be filed no later than September 1st for the upcoming assessment year in the BLM State Office where the mining claims or sites are recorded, or the waiver cannot be granted by the BLM. (Example: To obtain a waiver for the assessment year 2012, which begins on September 1, 2011, you must qualify for and file for a waiver no later than September 1, 2011, in the proper BLM State Office.)
8. For all mining claims which require assessment work, you must record an affidavit of labor on or before the December 30th immediately following the filing of this waiver. For all other mining claims or sites waived, you must record a notice of intent to hold on or before the December 30th immediately following the filing of this waiver.
9. Mill and tunnel sites may also be listed on this waiver and be waived from payment of the maintenance fee. A notice of intent to hold for these sites is required to be filed by the December 30th following the filing of this waiver.

PHOTOGRAPHY DIVISION

2019 SEP 11 10:30 AM

RECEIVED
BLM AZ STATE OFFICE

FOR OFFICIAL USE ONLY

When Recorded Return Document to:

Phillip L. Condrey
P.O. Box 684
11625 E. Mining Claim Trl.
Humboldt, AZ 86329

390605
395564
424954
429963

Check here if this is a change of address.

Telephone: 928 273-0550

E-mail address: plcondrey@gmail.com

AFFIDAVIT OF PERFORMANCE OF ANNUAL WORK

1. State of Arizona, County of Yavapai ss:
2. I (Name) Phillip L. Condrey
3. Reside at (Address) 11625 E. mining claim
Trail (P.O. Box 684)
City Humboldt County Yavapai

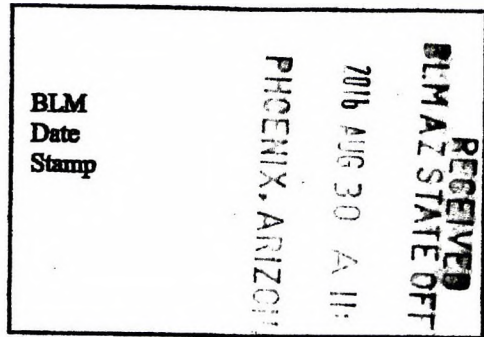

State AZ Zip 86329 being duly sworn, depose and say that I am a citizen of the United States, more than eighteen years of age, and that all of the facts set forth in this affidavit, subject to the provisions and penalties of 18 U.S.C. 1001 pertaining to the filing of false, fictitious, or fraudulent statements with the United States, are true and correct according to the best of my knowledge, information and belief.

4. Owner's name and address (if not shown in Items 1-3 above): _____

5. That I am personally acquainted with the mining claim(s). The work and improvements were made by and at the expense of the owner(s) of said claim(s). Said contiguous group of claims, listed on this document, are situated in the

(optional) Mining District: YAVAPAI County, Arizona.

Line No.	AMC NUMBER	CLAIM/SITE NAME	COUNTY RECORDER DATA (if available)	TWP	RNG	SEC
1	424954	Silver Queen		13 N	1 E	20
2	429963	Chaparral Gulch		13 N 13 N	1 E 1 W	30 25
3	390605	Swinder North	B-4576, P-277	13 N	1 E	33
4	395564	Forbach Ponds	B-4632, P-755	13 N	4 W	26
5						
6						

RECEIVED
BLM AZ STATE OFFICE
2016 AUG 30 A 11:12
PHOENIX, ARIZONA

BLM
Date
Stamp

7					
8					
9					
10					

6. That between the dates starting at 12 o'clock noon on September 1, 20 15 and ending at 12 o'clock noon on September 1, 20 16 at least \$ 700.00 dollars worth of work and improvements were done and performed upon said claim(s) or upon one or more of a contiguous group of claims for the benefit of all, wholly or partly outside of a contiguous group of claims for the benefit of all, not including the location work.

7. That the following persons were employed to perform the work and improvements described herein: Joe Osuna, Patrick Rudolph, Kevin Leonard, Warren Smith, and myself.

8. That the work and improvements performed were: Access Trails, road work, sampling, excavation, and water retainment

9. Dated: 8-25-16 Signature: Phillip L. Condroy

SUBSCRIBED AND SWORN TO before me, a Notary Public, this 25th day of AUGUST 20 16

By: Phillip L. Condroy

Notary Public Cynthia Hanson

My Commission Expires 6-26-2017

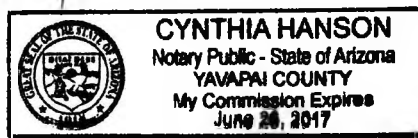

Bureau of Land Management
Arizona State Office
www.blm.gov/az

No. of Claims: 4 x \$10 = \$40.00
Check No.: 1064 Init. PHL
Receipt No.: 3647712
For BLM Use Only

United States Department of the Interior
Bureau of Land Management
 DIV OF LANDS, MINRLS & ENERGY
 ONE N CENTRAL AVE
 PHOENIX, AZ 85004 -4427
 Phone: 602-417-9200

Receipt

No: 3647712

Transaction #: 3751702	
Date of Transaction: 08/31/2016	
CUSTOMER:	
PHILLIP L CONDREY PO BOX 684 HUMBOLDT, AZ 86329-0684 US	

LINE #	QTY	DESCRIPTION	REMARKS	UNIT PRICE	TOTAL
1	1.00	LOCATABLE MINERALS / MINING CLAIMS-NOT NEW-UNADJUD, ONE AUTH NO. ONLY / MINING CLAIM MONEY RECEIVED CASES: AMC424954/\$40.00	WAIVER 2017 - 4 / POL 2016 - 4	- n/a -	40.00
TOTAL:					\$40.00

PAYMENT INFORMATION			
1	AMOUNT:	40.00	POSTMARKED: 08/26/2016
	TYPE:	CHECK	RECEIVED: 08/30/2016
	CHECK NO:	1064	
	NAME:	CONDREY, PHILLIP L 11625 E MINING CLIAM TRAIL HUMBOLDT AZ 86329-0684 US	

REMARKS

This receipt was generated by the automated BLM Collections and Billing System and is a paper representation of a portion of the official electronic record contained therein.

ENTERED
 SEP - 1 2016
 BY: *[Signature]*

C

Mr. Phillip L. Condrey
P.O. Box 684
Humboldt, AZ 86329-0684

RECEIVED
BLMAZ STATE OFFICE

2016 AUG 30 A 11:10

PHOENIX, ARIZONA

U.S. Department of the Interior
Bureau of Land Management
Arizona State Office

UNITED STATES
DEPARTMENT OF THE INTERIOR
BUREAU OF LAND MANAGEMENT

484

390605
395564
424954
429963
FORM APPROVED
OMB NO. 1004-0114
Expires: October 31, 2016

MAINTENANCE FEE WAIVER CERTIFICATION

SEE INSTRUCTIONS ON PAGE 2

- This small miner waiver is filed for the assessment year beginning on September 1, 2015 and ending on September 1, 2016.
- The undersigned and all related parties owned ten or fewer mining claims, mill, or tunnel sites located and maintained on Federal lands in the United States of America on September 1, 2015.
- The undersigned have performed the assessment work required by law for each mining claim listed prior to filing this waiver and understand that by filing this form, the undersigned must file an affidavit of assessment work with the Bureau of Land Management (BLM) by the December 30th following the filing of this waiver.
- The undersigned understand that if the assessment work obligation has not yet come due under 30 U.S.C. 28 (for those claims in their first assessment year only), a notice of intent to hold reciting this condition must be recorded by the December 30th following the filing of this waiver.
- The undersigned understand that mill and tunnel sites may also be listed on this waiver and be waived from payment of the maintenance fee, and that a notice of intent to hold for these sites is required to be filed with the BLM by the December 30th following the filing of this waiver.
- The undersigned understand and acknowledge that pursuant to 43 U.S.C. 1212 and 18 U.S.C. 1001, the filing or recording of a false, fictitious, or fraudulent document with the BLM may result in a fine of up to \$250,000, a prison term not to exceed five years, or both.
- The mining claims, mill or tunnel sites for which this waiver from payment of the maintenance fees is requested are:

CLAIM OR SITE NAME	BLM RECORDATION SERIAL NUMBER
1. Silver Queen	AMC 424954 ✓
2. Chaparral Gulch	AMC 429963
3. Swindler North	AMC 390605
4. Forbach Ponds	AMC 395564
5.	
6.	
7.	
8.	
9.	
10.	

The owner(s) (claimants) of the above mining claims and sites are:

Patrick Rudolph
(Owner's Name - Please Print)
14005 E. Wagon Wheel Dr.
(Owner's Mailing Address)

Patrick Rudolph
(Owner's Signature)
Dewey AZ 86327
(City) (State) (Zip Code)

Kevin Leonard
(Owner's Name - Please Print)
P.O. Box 943
(Owner's Mailing Address)

Kevin Leonard
(Owner's Signature)
Humboldt AZ 86329
(City) (State) (Zip Code)

Phillip L. Condrey
(Owner's Name - Please Print)
P.O. Box 684
(Owner's Mailing Address)

Phillip L. Condrey
(Owner's Signature)
Humboldt AZ 86329
(City) (State) (Zip Code)

Daniel A. Davis
(Owner's Name - Please Print)
1080 W. Coy Dr.
(Owner's Mailing Address)

Daniel Davis
(Owner's Signature)
Flagstaff AZ 86005
(City) (State) (Zip Code)

PM

NW
9/10/2015

Rhonda A. Davis

(Owner's Name - Please Print)

Rhonda A. Davis

(Owner's Signature)

1080 W. Coy Dr.

(Owner's Mailing Address)

Flagstaff

(City)

AZ

(State)

86005

(Zip Code)

Joseph P. Osuna

(Owner's Name - Please Print)

Joseph P. Osuna

(Owner's Signature)

12785 Stockmens Rd.

(Owner's Mailing Address)

Flagstaff

(City)

AZ

(State)

86004

(Zip Code)

Jennifer J. Osuna

(Owner's Name - Please Print)

Jennifer J. Osuna

(Owner's Signature)

12785 Stockmens Rd.

(Owner's Mailing Address)

Flagstaff

(City)

AZ

(State)

86004

(Zip Code)

(Owner's Name - Please Print)

(Owner's Signature)

(Owner's Mailing Address)

(City)

(State)

(Zip Code)

18 U.S.C. 1001 and 43 U.S.C. 1212 make it a crime for any person knowingly and willfully to make to any department or agency of the United States any false, fictitious or fraudulent statements or representations as to any matter within its jurisdiction.

INSTRUCTIONS

1. This certification is made under the provisions of 43 U.S.C. § 1744 and 30 U.S.C. §28-28k and the regulations thereunder (43 CFR Part 3830).
2. The claimant(s) must fill in the dates in paragraph 1 for the beginning and ending of the assessment year for which this waiver is sought.
3. The claimant(s) must fill in the date in paragraph 2 for the beginning of the assessment year for which this waiver is sought.
4. All claim and site names and BLM serial numbers must be listed for the mining claims, mill sites, and tunnel sites for which the waiver is sought.
5. All owners of the mining claims, mill sites, and tunnel sites and their addresses must be given.
6. This waiver form must be signed by all the claimants or their designated agent, in original form. If an agent is designated, a notarized designation of agent, signed by all of the claimants with proper address given, must be submitted with this waiver.
7. This form must be filed no later than September 1st for the upcoming assessment year in the BLM State Office where the mining claims or sites are recorded, or the waiver cannot be granted by the BLM. (Example: To obtain a waiver for the assessment year 2012, which begins on September 1, 2011, you must qualify for and file for a waiver no later than September 1, 2011, in the proper BLM State Office.)
8. For all mining claims which require assessment work, you must record an affidavit of labor on or before the December 30th immediately following the filing of this waiver. For all other mining claims or sites waived, you must record a notice of intent to hold on or before the December 30th immediately following the filing of this waiver.
9. Mill and tunnel sites may also be listed on this waiver and be waived from payment of the maintenance fee. A notice of intent to hold for these sites is required to be filed by the December 30th following the filing of this waiver.

FOR OFFICIAL USE ONLY

2015 AUG 28 4 10:51 PM

When Recorded Return Docum to:

Phillip L. Coondrey
P.O. Box 684
11625 E. Mining Claim Trl.
Humboldt, AZ 86329-0684

390605
395564
424954
429963

Check here if this is a change of address.

Telephone: 928 273-0550

E-mail address: p.coondrey@gmail.com

AFFIDAVIT OF PERFORMANCE OF ANNUAL WORK

1. State of Arizona, County of Yavapai ss:
2. I (Name) Phillip L. Coondrey
3. Reside at (Address) 11625 E. Mining Claim
Trail (P.O. Box 684)
City Humboldt County Yavapai

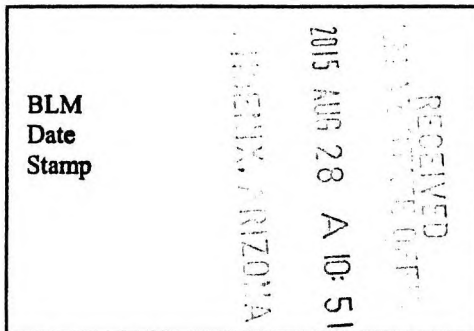

State AZ Zip 86329 being duly sworn, depose and say that I am a citizen of the United States, more than eighteen years of age, and that all of the facts set forth in this affidavit, subject to the provisions and penalties of 18 U.S.C. 1001 pertaining to the filing of false, fictitious, or fraudulent statements with the United States, are true and correct according to the best of my knowledge, information and belief.

4. Owner's name and address (If not shown in Items 1-3 above) _____

5. That I am personally acquainted with the mining claim(s). The work and improvements were made by and at the expense of the owner(s) of said claim(s). Said contiguous group of claims, listed on this document, are situated in the

_____ (optional) Mining District; Yavapai County, Arizona.

Line No.	AMC NUMBER	CLAIM/SITE NAME	COUNTY RECORDER DATA (If available)	TWP	RNG	SEC
1	424954	Silver Queen		13 N	1 E	20
2	429963	Chaparral Gulch		13 N 13 N	1 E 1 W	30 25
3	390605	Swindler North	B-4576, P-277	13-N	1-E	33
4	395564	Forbach Ponds	B-4632, P-755	13-N	4-W	26
5						
6						

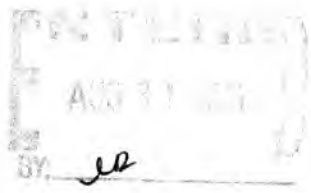

BLM
Date
Stamp

2015 AUG 28 A 10:51
YAVAPAI COUNTY, ARIZONA

RECEIVED

7					
8					
9					
10					

6. That between the dates starting at 12 o'clock noon on September 1, 20 14 and ending at 12 o'clock noon on September 1, 20 15 at least \$ 500.00 dollars worth of work and improvements were done and performed upon said claim(s) or upon one or more of a contiguous group of claims for the benefit of all, wholly or partly outside of a contiguous group of claims for the benefit of all, not including the location work.

7. That the following persons were employed to perform the work and improvements described herein: Joe Osuna, Kevin Leonard, Patrick Rudolph, Warren Smith, and myself.

8. That the work and improvements performed were: Road work, access trails, water retainment, sampling, and excavation

9. Dated: 8-24-15 Signature: Phillip L. Condey

SUBSCRIBED AND SWORN TO before me, a Notary Public, this 24th day of August 20 15

By: Phillip Condey

Notary Public [Signature]

My Commission Expires 12/6/17

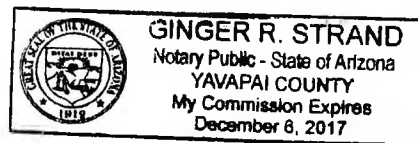

Bureau of Land Management
Arizona State Office
www.az.blm.gov

No. of Claims: 4 x \$10 = 40.00
Check No.: 1034 Init. [Signature]
Receipt No.: 3379565
For BLM Use Only

United States Department of the Interior
Bureau of Land Management
 LANDS/RECREATION & PLANNING
 ONE N CENTRAL AVE
 PHOENIX, AZ 85004 -2203
 Phone: 602-417-9200

Receipt

No: 3379565

Transaction #: 3477830	
Date of Transaction: 08/28/2015	
CUSTOMER:	
PHILLIP L CONDREY PO BOX 684 HUMBOLDT, AZ 86329-0684 US	

LINE #	QTY	DESCRIPTION	REMARKS	UNIT PRICE	TOTAL
1	1.00	LOCATABLE MINERALS / MINING CLAIMS- NOT NEW-UNADJUD, ONE AUTH NO. ONLY / MINING CLAIM MONEY RECEIVED CASES: AMC424954/\$40.00	2016 WAIV & 2015 POL (4)	- n/a -	40.00
TOTAL:					\$40.00

PAYMENT INFORMATION			
1	AMOUNT:	40.00	POSTMARKED: N/A
	TYPE:	CHECK	RECEIVED: 08/28/2015
	CHECK NO:	1034	
	NAME:	CONDREY, PHILLIP L PO BOX 684 HUMBOLDT AZ 86329-0684 US	

REMARKS

This receipt was generated by the automated BLM Collections and Billing System and is a paper representation of a portion of the official electronic record contained therein.

ENTERED
 AUG 31 2015
 BY: *ee*

NOTICE!!

These documents have been scanned!

Do not place un-scanned documents beneath this notice!

Do not remove this notice from this file!

GPO Jacket No. 560-102
Print Order 61540
Rise Business Services, LLC
Job=AZ15 5/10/2019



Box Number= AZ15031



Claim Begin-End: AMC429963-AMC429963

5 Miscellaneous



AZ15031-24

AMC429540-AMC429995

Authorized Date07/15/2015

Instructions to AccountsAZ BLM REFUND \$155, TO SOLACIUM ENTERPRISES LLC, FOR
OVERPAYMENT OF MAINTENANCE FEE, ON AMC429963, RECEIPT
#3170082. RM

Login ID6222

Entry Date07/15/2015

Total Amount\$155.00

AMC 429963

United States Department of the Interior
Bureau of Land Management
 LANDS/RECREATION & PLANNING
 ONE N CENTRAL AVE
 PHOENIX, AZ 85004 -2203
 Phone: 602-417-9200

Receipt

No: 3336926

Transaction #: 3434475	
Date of Transaction: 07/07/2015	
CUSTOMER:	
PHILLIP L CONDREY PO BOX 684 HUMBOLDT, AZ 86329-0684 US	

LINE #	QTY	DESCRIPTION	REMARKS	UNIT PRICE	TOTAL
1	1.00	LOCATABLE MINERALS / MINING CLAIMS- NOT NEW-UNADJUD.ONE AUTH NO. ONLY / MINING CLAIM MONEY RECEIVED CASES: AMC429963/\$10.00	AMEND/1	- n/a -	10.00
TOTAL:					\$10.00

PAYMENT INFORMATION					
1	AMOUNT:	10.00	POSTMARKED:	07/02/2015	
	TYPE:	CHECK	RECEIVED:	07/06/2015	
	CHECK NO:	1032			
	NAME:	CONDREY, PHILLIP PO BOX 684 HUMBOLDT AZ 86329-0684 US			

REMARKS

This receipt was generated by the automated BLM Collections and Billing System and is a paper representation of a portion of the official electronic record contained therein.

*AMENDMENT FOR AMC 429963
 PROCESSED. 7/9/2015 RM*





Phillip L
PO Box 307
Humboldt, AZ 86329-0684

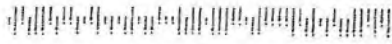

RECEIVED
BLM ARIZONA OFFICE
2015 JUL -6 P 3:00
PHOENIX, ARIZONA



Attn: Reann Meyers
U.S. Dept. of Interior
Bureau of Land Management
Arizona State Office
One N. Central Ave., Suite 800
Phoenix, AZ 85004-4427

Dear Reann Meyer:

I enclosed a second amendment to our AMC 429963 placer claim. I defined the best I could, without an example. A \$10 check enclosed.

We had to pay for two claims of acreage. If the placer claim acreage is open for a claim NNE up Chaparral Gulch extending down the gulch from our claim, we would apply our refund to place a placer claim on that acreage.

Please advise, Thank you.

Respectfully yours,
Phillip L. Condrey

928 273-0550

PHOENIX, ARIZONA

2015 JUL -6 P 3:00

PHOENIX, ARIZONA

AMC 429963

LOCATION NOTICE FOR PLACER MINING CLAIM

Amendment BLM Serial # AMC 429963

NOTICE IS HEREBY GIVEN that the CHARPARRAL
Gulch placer mining claim has been located by

Phillip Condrey & Patrick Rudolph whose current mailing
address is P.O. Box 687, Humboldt, AZ 86328
& 4405 E. Wagon Wheel Dr, Dewey, AZ, 86327

BLM
Date
Stamp

RECEIVED
BLM STATE OFFICE
2015 JUN 17 A 11:41
PHOENIX, ARIZONA

The general course of this claim is NFE and it is situated in YAVAPAI Co
County, Arizona. This claim is 660x feet in length and 1320 feet in width.

20 Total Claim Acreage. This claim runs from the location monument on which this location notice is
posted at the SE corner of the claim approximately 1320 feet in a NEE direction to the
EAST end line and 660 feet in a NNW direction to the North end line. This claim is
marked by four monuments, one at each corner of the claim.

The location monument on which this notice is posted is situated within Section 25 Township
13 N, Range 1 W, Gila Salt River Base and Meridian, Arizona. This claim encompasses
portions of the following legal subdivision(s) if located by legal subdivision or the following quarter section(s),
section(s), Township(s) and Range(s) NE 1/4, S25, T13N, R1W, NW 1/4
S30, T13N, R1E, Gila Salt River Base and Meridian, Arizona.

The locality of this claim with reference to some natural object or permanent monument and additional information
(if any) concerning its locality are as follows: MT. Elliott Spring is about
5100 ft SW of the claim's NW claim marker

The above information is shown on the attached map.

DATED AND POSTED on the ground this 13 day of June, 2015.

LOCATOR(s) AGENT

Print Name(s) Phillip L. Condrey / Patrick C. Rudolph

Signature(s) Phillip L. Condrey / Patrick C. Rudolph

Form MCF102
Revised July 2014

This form is available from the Arizona Geological Survey and may be reproduced.

SPOKE W/ MR. CONDREY ABOUT
NOT TAKING IN NEW GROUND 6/23
AND USING METRE 3 BOUNDS DESCRIPTION
NEW AMENDMENT RECEIVED 7/6/15.
AM

BY: AM

MINING CLAIM MAP

Lode () Placer ()
Millsite ()

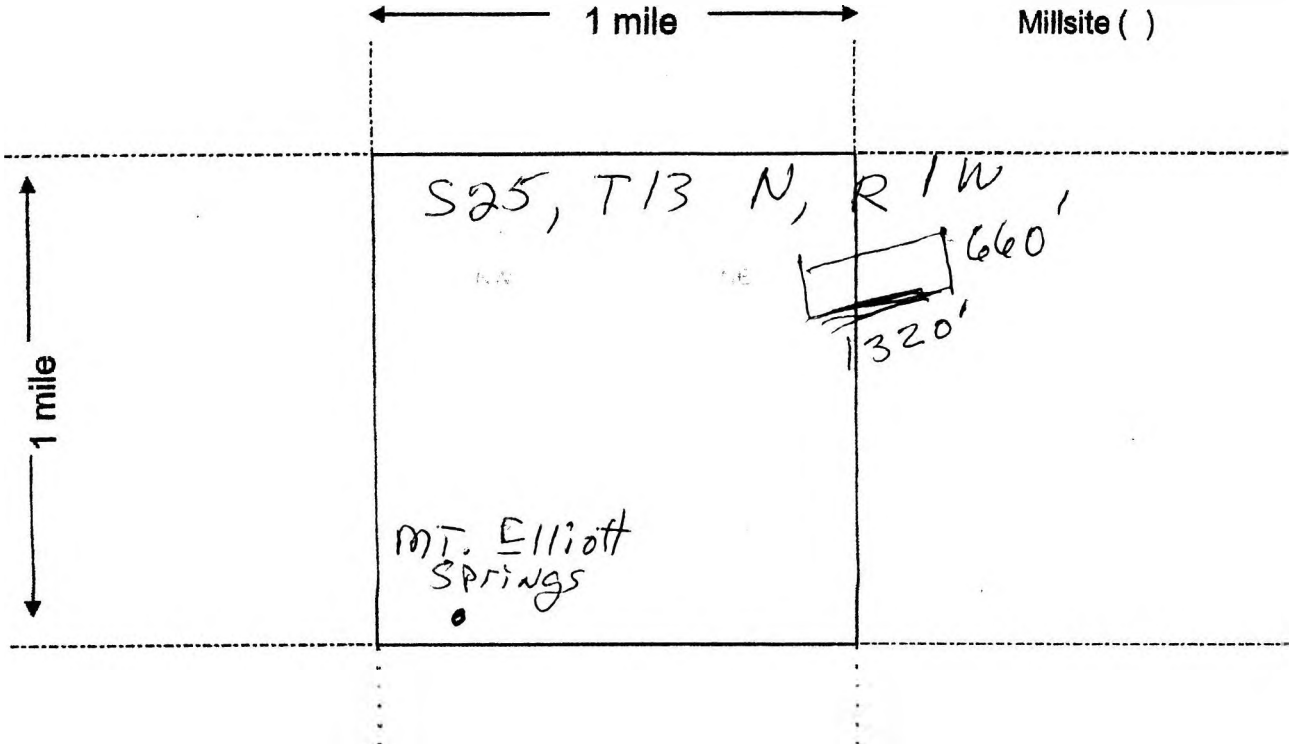

Scale: 1" = 2000 feet



1. The above map depicts the Chaparral Gulch mining claim, which is located in Section (s) 25 & 30, Township 13 N, Range 1 W, Gila and Salt River Base and Meridian, YAVAPAI County, Arizona. Total claim acreage is 20

2. The type of corner and location monuments used are as follows: 7 posts with a red cap 2" diameter PVC white 5' High @ each corner

3. The bearings and distances in degrees and feet between claim corners and to a public land survey monument are as depicted on the map.

4. If the claim is a placer or millsite claim with exterior limits conforming to legal subdivisions of the public survey, provide a legal description of the claim NE Quarter, Section 25, T13N, R1W, NW Quarter, Section 30, T13N, R1E

Form MCF100a
Revised July 2014



United States Department of the Interior

BUREAU OF LAND MANAGEMENT
Arizona State Office
One North Central Avenue, Suite 800
Phoenix, Arizona 85004-4427
www.blm.gov/az/



MAY 13 2015

In Reply Refer To:
3800 (9310) RM
AMC429963

RECEIVED
BLM AZ STATE OFFICE
2015 JUN 17 9A 11:42
PHOENIX, ARIZONA

CERTIFIED MAIL - RETURN RECEIPT REQUESTED No. 7014 0150 0000 5453 6896

NOTICE

PHILLIP CONDREY : This Notice Affects the Claims
PO BOX 684 : Shown in the Block Below.
HUMBOLDT, AZ 86329-0684 :

AMC429963
CHAPARRAL GULCH

Mining Claim Location Notice – Amendment Required

Pursuant to Title 43 Code of Federal Regulations (CFR) 3832.1, this office received your notices of location for recording mining claims. In accordance with 43 CFR 3832.12, the claims listed above cannot be accepted as filed and must be amended as noted below.

1. Your claim contains excess acreage. A placer claim located by one locator can only contain 20 acres. Your claim dimensions are 1500 x 600, which equals 20.66 acres. You must file an amendment to reduce your claim to 20 acres. Please be aware that 1500 x 600 are the dimensions for a Lode mining claim. If you mistakenly filed a Placer claim rather than a Lode claim, you should relinquish this claim and relocate it correctly. You cannot change the type of claim from a Placer to a Lode with an amendment. If you amend your claim, be aware that you cannot take in new ground with an amendment. Therefore, the width of the claim would have to remain 600 feet and the length would need to be reduced to at least 1320 feet.

2. The placer mining claim listed above is located diagonally and does not conform to the U.S. Public Land Survey System and its rectangular subdivisions, as required.

In accordance with 43 CFR 3832.12(c) (1) You must describe placer claims by aliquot part and complete lots using the U.S. Public Land Survey System and its rectangular subdivisions except when placer claims are (i) on unsurveyed Federal lands; (ii) Gulch or bench placer claims; or (iii) Bounded by other mining claims or nonmineral lands. If one of these situations exists you

must describe the lands by protracted survey or by metes and bounds. The amendment must provide one of the following:

- a) Identify which situation exists to allow a placer to be located by metes and bounds and provide a metes and bounds description; or
- b) Locate the mining claim using the U.S. Public Land Survey System and its rectangular subdivisions and describe the mining claim by aliquot parts and complete lots.

If the claim is to be described by aliquot parts and complete lots, it may result in a claim that contains significantly less acreage than was originally located. If you wish to retain the same acreage, you may want to relocate the claim correctly, rather than amend the incorrectly located claim.

There is a \$10 Bureau of Land Management processing fee for each amendment. We must receive the amendments within 30 days of your receipt of this notice. If the amendments are not received within the 30-day timeframe the mining claims will be declared null and void.

If additional information is required, please contact RéAnn Myers at 602-417-9413. Please include your AMC serial number(s) on all correspondence.

Sincerely,

Michael J Werner
for

Rebecca Heick
Acting Deputy State Director
Lands and Minerals Division

RECEIVED
AZ STATE OFFICE
2015 JUN 17 A 11:42
PHOENIX, ARIZONA

United States Department of the Interior
Bureau of Land Management
 LANDS/RECREATION & PLANNING
 ONE N CENTRAL AVE
 PHOENIX, AZ 85004 -2203
 Phone: 602-417-9200

Receipt

No: 3323605

Transaction #: 3420911	
Date of Transaction: 06/17/2015	
CUSTOMER:	
PHILLIP L CONDREY PO BOX 684 HUMBOLDT, AZ 86329-0684 US	

LINE #	QTY	DESCRIPTION	REMARKS	UNIT PRICE	TOTAL
1	1.00	LOCATABLE MINERALS / MINING CLAIMS- NOT NEW-UNADJUD, ONE AUTH NO. ONLY / MINING CLAIM MONEY RECEIVED CASES: AMC429963/\$10.00	AMEND/1	- n/a -	10.00
TOTAL:					\$10.00

PAYMENT INFORMATION					
1	AMOUNT:	10.00	POSTMARKED:	N/A	
	TYPE:	CASH	RECEIVED:	06/17/2015	
	NAME:	CONDREY, PHILLIP L PO BOX 684 HUMBOLDT AZ 86329-0684 US			

REMARKS
928.273.0550 — <i>Re Ann please call if any problems - tmx</i>

This receipt was generated by the automated BLM Collections and Billing System and is a paper representation of a portion of the official electronic record contained therein.

NOTICE!!

These documents have been scanned!

Do not place un-scanned documents beneath this notice!

Do not remove this notice from this file!

GPO Jacket No. 560-102
Print Order 61540
Rise Business Services, LLC
Job=AZ15 5/10/2019



Box Number= AZ15031



Claim Begin-End: AMC429963-AMC429963

6 Location Notices-Amendments and Supporting Documents



AZ15031-24

AMC429540-AMC429995

MINING CLAIM STATUS REPORT

Data Entered: 11/21/14 RHM

MTP Checked By: JMC

GEO Checked By: JMC

LEAD SERIAL NUMBER: AMC 429963 thru AMC _____

NUMBER OF CLAIMS & TYPE:

eez LODE
1 PLACER
ASSOCIATION PLACER
MILL SITE
TUNNEL SITE

CHARGES:

Location Fee @ \$37 = \$ 74 37
Processing Fee @ \$20 = \$ 40 20
Maintenance Fee @ \$155 = \$ 310 155
Add'l Maint Fee for Assoc Placer = \$ 55 310 per 167 acres
SUBTOTAL \$ _____
Other Fees \$ _____
Other Fees \$ _____
TOTAL \$ 734 367.00

TOTAL ACREAGE: 20.67 Per Claim
(Placer Only)

NUMBER OF LOCATORS: 2

DOCUMENTS RECEIVED VIA: Over-the-Counter [] Mail [] **TIMELY FILED:** Yes [] No []

LEGAL DESCRIPTION: T 13N R 1W SEC 25, 30
T _____ R _____ SEC _____
T _____ R _____ SEC _____
T _____ R _____ SEC _____
T _____ R _____ SEC _____

BLM [] FOREST SERVICE [] Prescott NF SUBJ TO PL 359: Yes [] No []
WILDERNESS AREA [] _____

SPLIT ESTATE: N/A [] SX [] PX [] OTHER [] _____
SRHA [] Was proper Notice filed if located on SHRA Land? Yes [] No []

RECONVEYED MINERALS ON BLM LAND REQUIRE OPENING ORDER FROM 1944 TO 1993:

Open to Entry On _____ N/A []

COMMENTS/STATUS: VOID [] PARTIALLY VOID [] PVT MINERALS [] WITHDRAWN LANDS []
OTHER [] _____

not certain about Ti conderoga claim - map? - title Customer
Chose not to file 2nd location

[] Claimant acknowledges that portions of the following claim(s) site(s) may be void or voidable.

Printed Name of Claimant _____ Signature of Claimant _____

*****FINAL ADJUDICATION*****

DATE 5-5-2015 INITIALS JM

AMC 429963

Phillip L. Condrey
P.O. Box 684
Humboldt, AZ 86329-0684

LOCATION NOTICE FOR PLACER MINING CLAIM

Amendment BLM Serial # Amc 429963

BLM
Date
Stamp
PHOENIX, ARIZONA
2015 JUL -6 P 3:01
RECEIVED

NOTICE IS HEREBY GIVEN that the Chaparral
Gulch placer mining claim has been located by
Phillip L. Condrey, Patrick C. Rudolph whose current mailing
address is (PO) P.O. Box 684, Humboldt, AZ 86329

(PR) 14005 E. Wagon Wheel Dr, Dewey, AZ 86327

The general course of this claim is ENE - WSW and it is situated in Yavapai
County, Arizona. This claim is 1320 feet in length and 600 feet in width.

18.18 Total Claim Acreage. This claim runs from the location monument on which this location notice is
posted at the SW corner of the claim approximately 600 feet in a NNW direction to the
N end line and 1320 feet in a ENE direction to the E end line. This claim is
marked by four monuments, one at each corner of the claim.

The location monument on which this notice is posted is situated within Section 25, Township
13 N, Range 1 W, Gila Salt River Base and Meridian, Arizona. This claim encompasses
portions of the following legal subdivision(s) if located by legal subdivision or the following quarter section(s),
section(s), Township(s) and Range(s) NE 1/4, Sect. 25, T13N, R1W;
NW 1/4, Sect. 30, T13N, R1E, Gila Salt River Base and Meridian, Arizona.

The locality of this claim with reference to some natural object or permanent monument and additional information
(if any) concerning its locality are as follows: Sec. 25 - NE section corner marker
measurements to claim corners: NW - 1650', 205'; SW - 2050'
194.5'; NE - 920', 156'; SE - 1550', 153.5' The above information is shown on the attached map.

DATED AND POSTED on the ground this 13 day of June, 2015 AMENDMENT

LOCATOR(s) AGENT

Print Name(s) Phillip L. Condrey, Patrick C. Rudolph

Signature(s) Phillip L. Condrey, Patrick C. Rudolph

Form MCF102
Revised July 2014

3 21 34475

Amc 429963

Measurements in degrees and feet from NE corner - Sec 25

NW: About, 205°, 1650'

SW: About, 194.5°, 2050'

NE: About, 156°, 420'

SE: About, 153.5°, 1550'

MINING CLAIM MAP

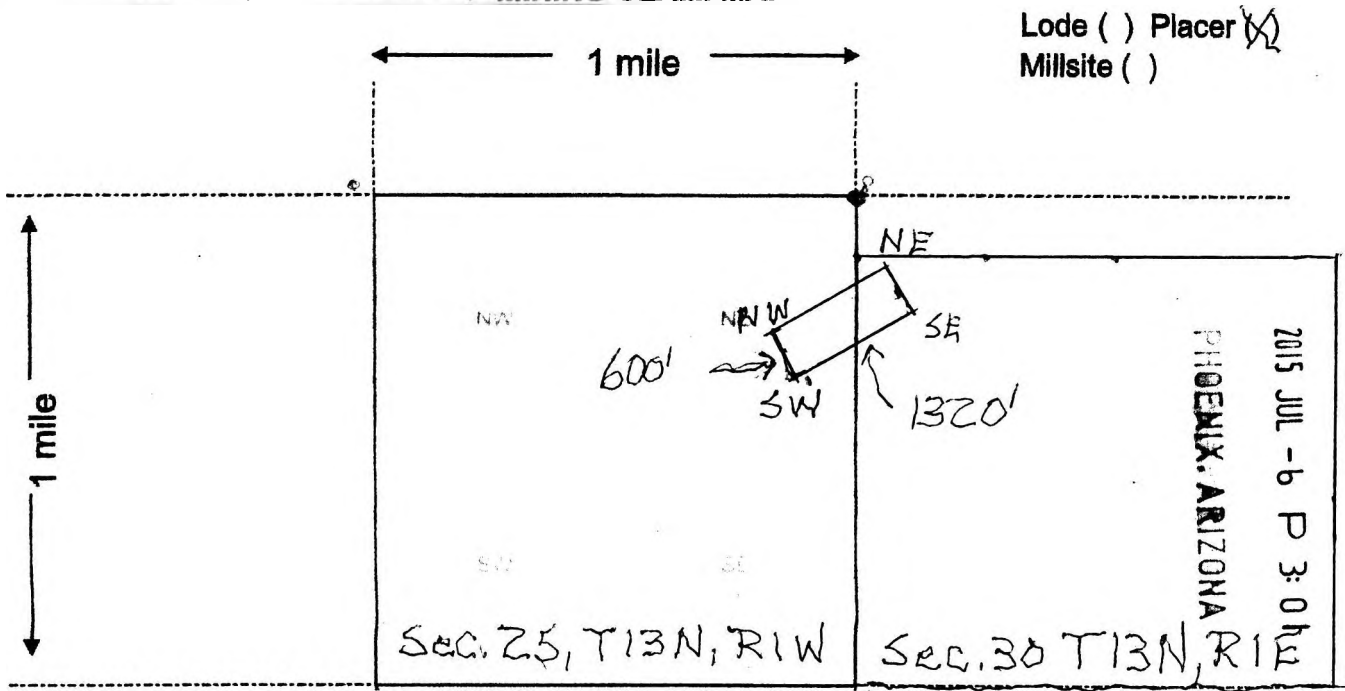

Scale: 1" = 2000 feet



1. The above map depicts the Chaparral Gulch mining claim, which is located in Section (s) 25 30, Township 13 13 N, Range 1 1 W E, Gila and Salt River Base and Meridian, Yavapai County, Arizona. Total claim acreage is 18.18

2. The type of corner and location monuments used are as follows: T-posts, with a red cap, 2" diameter white PVC pipe, 5' high at each corner.

3. The bearings and distances in degrees and feet between claim corners and to a public land survey monument are as depicted on the map.

4. If the claim is a placer or millsite claim with exterior limits conforming to legal subdivisions of the public survey, provide a legal description of the claim _____

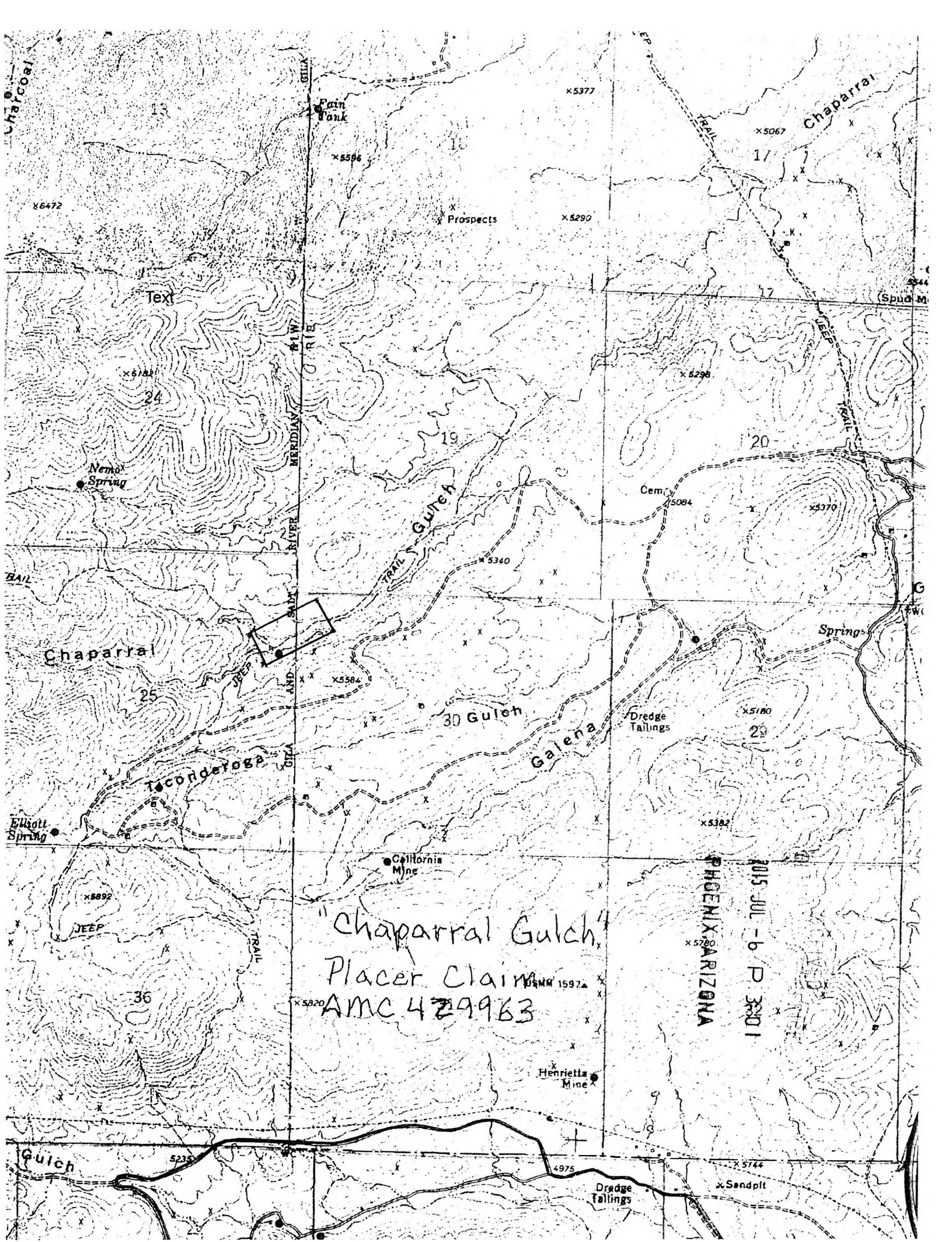

Chaparral Gulch
Placer Claim
AMC 429963

PHOENIX, ARIZONA
2015 JUL - 6 P 3:01



Phillip L. Condrey
P.O. Box 684
Humboldt, AZ 86329

LOCATION NOTICE FOR PLACER MINING CLAIM

NOTICE IS HEREBY GIVEN that the Chaparral
Guich placer mining claim has been located by
Phillip L. Condrey, Patrick C. Rudolph whose current mailing
address is (PC) P.O. Box 684, Humboldt, AZ 86329
(PR) 14005 E. Wagon Wheel Dr, Dewey AZ 86327

RECEIVED
AZ STATE OFFICE
2014 NOV 17 A 10:52
PHOENIX, ARIZONA
BLM
Date
Stamp

The general course of this claim is NEE and it is situated in
YAVAPAI
County, Arizona.

This claim is 1500 feet in length and 600 feet in width. This claim runs from the
location monument on which this location notice is posted approximately 1500 feet in a NEE
direction to the EAST end line and 600 feet in a SEK direction to the South end line.
This claim is marked by four monuments, one at each corner of the claim.

The location monument on which this notice is posted is situated within Section 25, Township
13 N, Range 1 W, Gila Salt River Base and Meridian, Arizona. This claim encompasses
portions of the following legal subdivision(s) if located by legal subdivision or the following quarter section (s),
section (s), Township (s) and Range (s) NE 1/4, Sect. 25, T13N, R1W; NW 1/4,
Sect. 30, T13N, R1E, Gila Salt River Base and Meridian, Arizona.

The locality of this claim with reference to some natural object or permanent monument and additional
information (if any) concerning its locality are as follows: mt. Elliott spring is about
500 ft. SW of the claim's NW corner marker

DATED AND POSTED on the ground this 17 day of October, 2014.

LOCATOR (S) Phillip L. Condrey, Patrick C. Rudolph
Phillip L. Condrey, Patrick C. Rudolph

Form MCF102
Revised July 2005

AMC429963

MINING CLAIM MAP

Lode () Placer

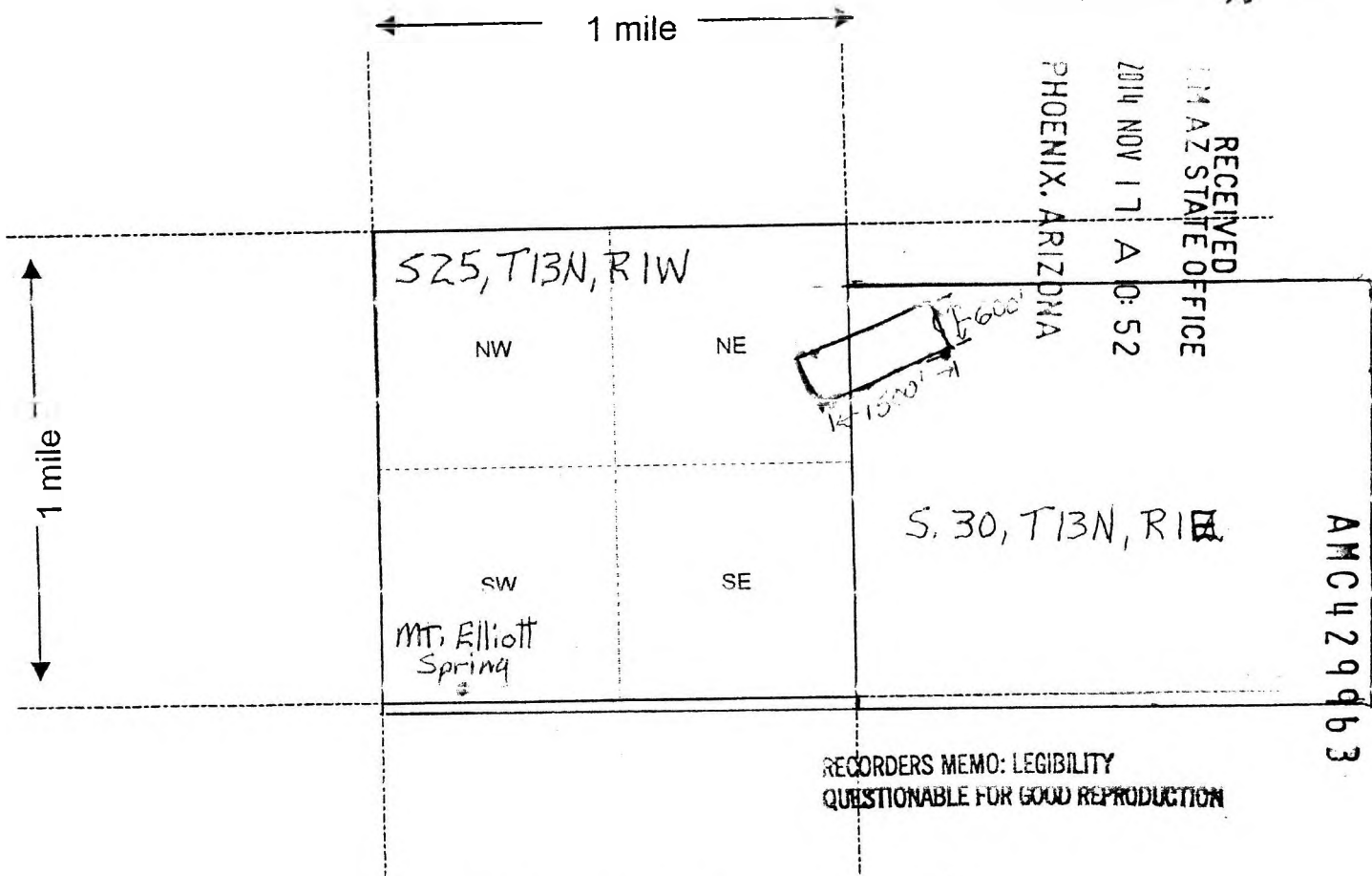

Scale : 1" = 2000 feet



1. The above map depicts the Chaparral Gulch mining claim, which is located in Section (s) 25 / 30, Township 13 / 13 N / N, Range 11 W / E, Gila and Salt River Base and Meridian, Yavapai County, Arizona.

2. The type of corner and location monuments used are as follows: T-posts, with a capped 2 in diameter PVC white pipe at each corner.

3. The bearings and distances in degrees and feet between claim corners are as depicted on the map.

Form MCF100a
Revised July 2005

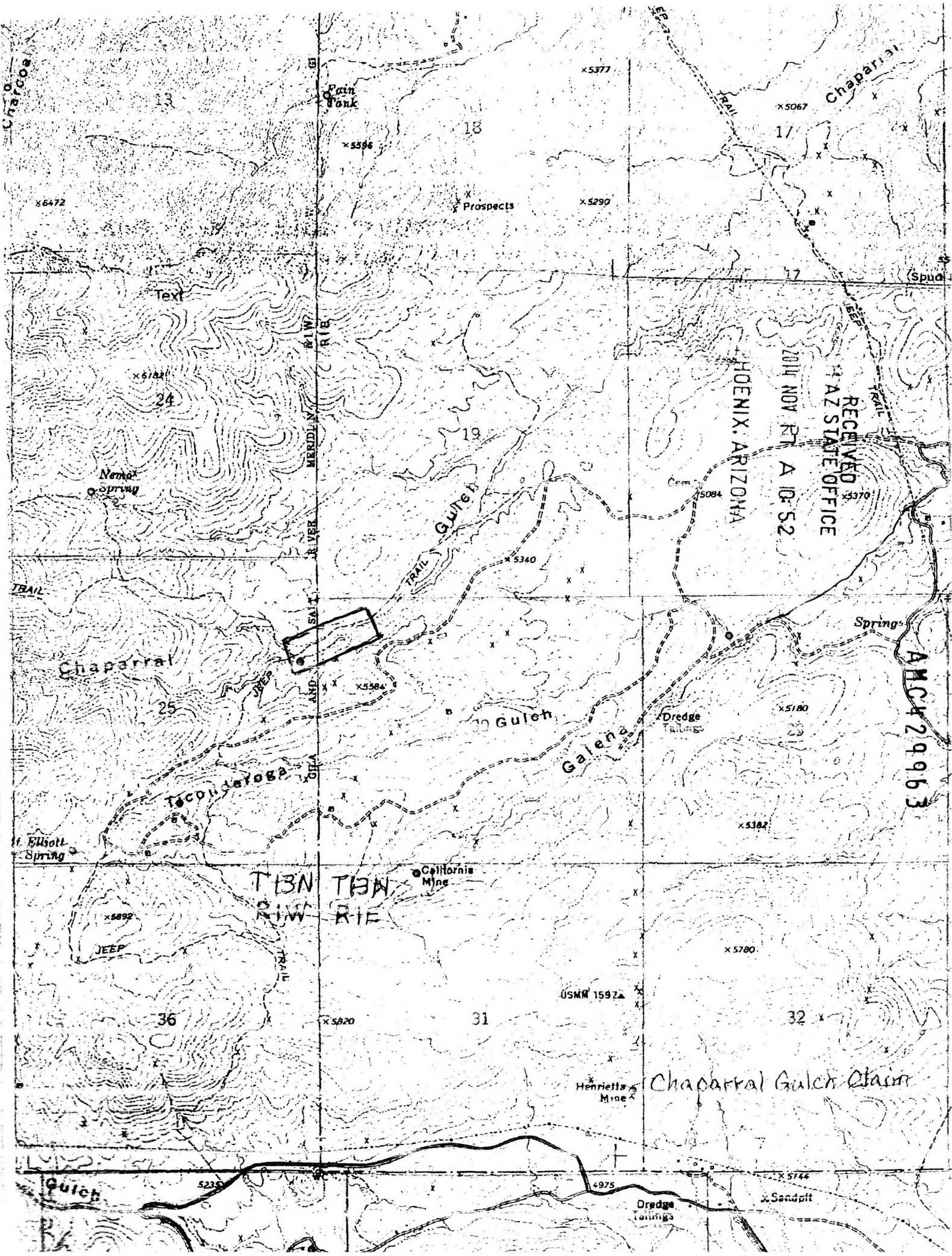

RECEIVED
AZ STATE OFFICE
NOV 14 10:52 AM

ANCH 29963

PHOENIX, ARIZONA

TUCSON RIVER

Chaparral Gulch claim

Chaparral

Chaparral

Chaparral

Elliott Spring

California Mine

Henrietta Mine

Gulch

Dredge Tailings

Sandpit

13

18

17

19

24

25

36

31

32

x5396

x5377

x5067

x6472

Prospects

x5290

x6782

x5084

x5370

x5340

x5584

x5180

x5382

x5892

x5780

x5820

USMW 1592A

5215

4975

x5744

Text

Nemat Spring

Spring

JEEP

Dredge Tailings

DEPARTMENT OF INTERIOR
BUREAU OF LAND MANAGEMENT

Input Parameters for Geographic Report with Land

System Id = CR

Admin State = AZ

Geo State =

Casetype Begins With

Case Disp Txt = AUTHORIZED, CANCELLED, EXPIRED, PENDING, REJECTED, RELINQUISHED, VOID, WITHDRAWN

Mer Twp Rng =

Section =

Mtrs = 14 0130N 0010W 025, 14 0130N 0010W 999

Commodity =

Commodity Txt =

Pending Org =

Pend Org Decode =

Total Rows Returned: 0

Input Parameters for Geographic Report with Land

System Id = CR

Admin State = AZ

Geo State =

Casetype Begins With

Case Disp Txt =

Mer Twp Rng = 14 0130N 0010E

Section = 030, 999

Mtrs =

Commodity =

Commodity Txt =

Pending Org =

Pend Org Decode =

Total Rows Returned: 5

RUN TIME: 12:42 PM

UNITED STATES DEPARTMENT OF INTERIOR
BUREAU OF LAND MANAGEMENT
GEOGRAPHIC REPORT WITH LAND
Sorted by Serial Number

RUN DATE: 04/07/2015
Page 1 of 1

Adm State: AZ

Serial Number: AZA 027323
Total Case Acres: 1.000

<u>Casetype</u>	<u>Case Disp</u>	14	0130N	0010E	<u>Sect</u>	<u>Sur Typ</u>	<u>Sur Num</u>	<u>Suff</u>	<u>Subdivision</u>	<u>Act Pend</u>
380910	CLOSED				030	FF		1	PART OF ALL;	

Serial Number: AZA 027557
Total Case Acres: 1.000

<u>Casetype</u>	<u>Case Disp</u>	14	0130N	0010E	<u>Sect</u>	<u>Sur Typ</u>	<u>Sur Num</u>	<u>Suff</u>	<u>Subdivision</u>	<u>Act Pend</u>
380913	CLOSED				030	FF		1	PART;	

Serial Number: AZA 027600
Total Case Acres: 1.000

<u>Casetype</u>	<u>Case Disp</u>	14	0130N	0010E	<u>Sect</u>	<u>Sur Typ</u>	<u>Sur Num</u>	<u>Suff</u>	<u>Subdivision</u>	<u>Act Pend</u>
380913	CLOSED				030	FF		1	PART;	

Serial Number: AZA 031357
Total Case Acres: 1.000

<u>Casetype</u>	<u>Case Disp</u>	14	0130N	0010E	<u>Sect</u>	<u>Sur Typ</u>	<u>Sur Num</u>	<u>Suff</u>	<u>Subdivision</u>	<u>Act Pend</u>
380913	CLOSED				030	ALIQ			ALL;	

Serial Number: AZA 036221
Total Case Acres: 1.000

<u>Casetype</u>	<u>Case Disp</u>	14	0130N	0010E	<u>Sect</u>	<u>Sur Typ</u>	<u>Sur Num</u>	<u>Suff</u>	<u>Subdivision</u>	<u>Act Pend</u>
380913	PENDING				030	FF			NE(PART);	

TOWNSHIP 13 NORTH RANGE 1 WEST OF THE GILA AND SALT RIVER MERIDIAN, ARIZONA

YAVAPAI COUNTY

STATUS OF PUBLIC DOMAIN
LAND AND MINERAL TITLES

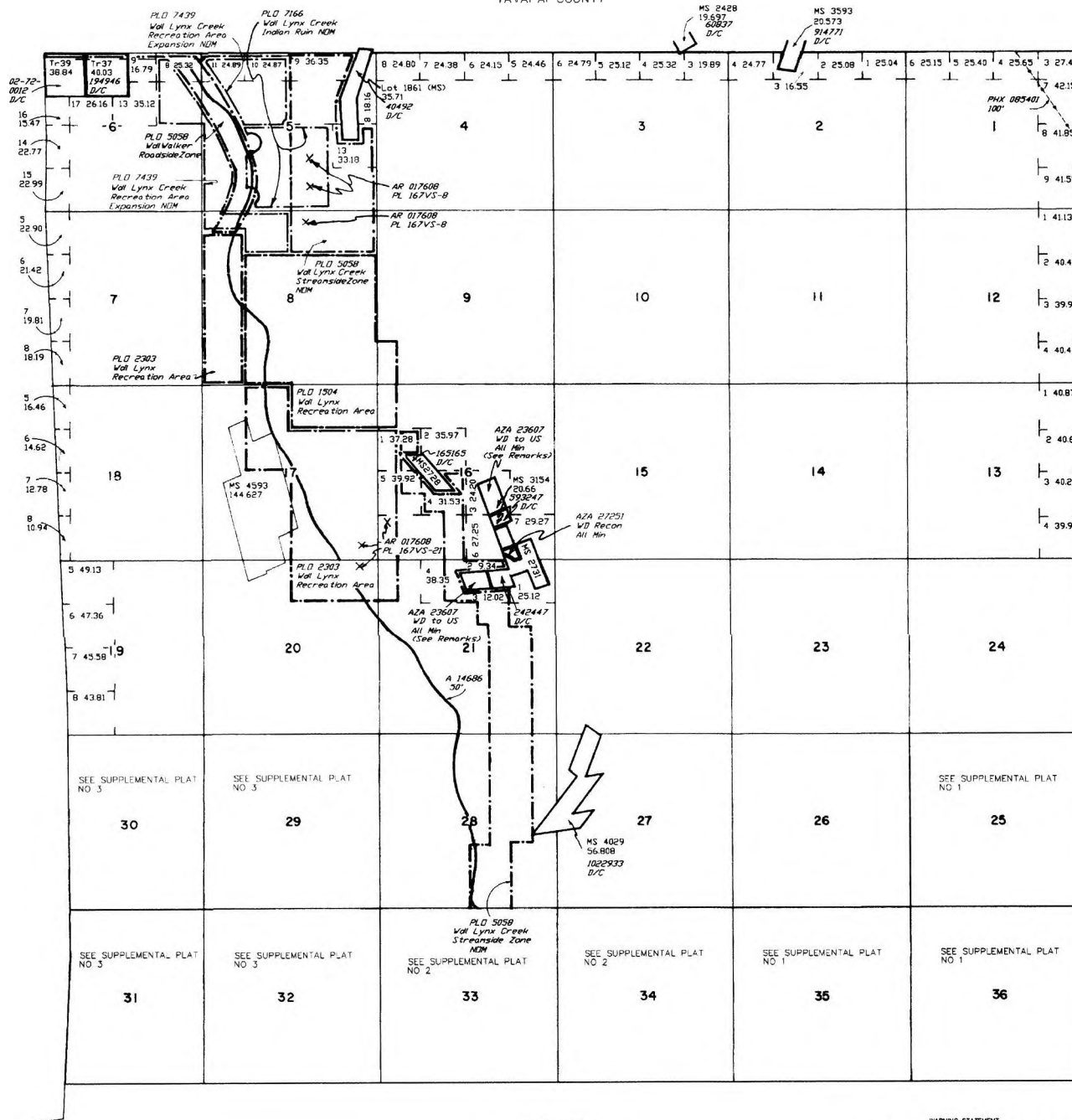

FOR ORDERS AFFECTING DISPOSAL OR USE OF UNIDENTIFIED LANDS WITHDRAWN FOR CLASSIFICATION, MINERALS, WATER AND/OR OTHER PUBLIC PURPOSES, REFER TO INDEX OF MISCELLANEOUS DOCUMENTS.

DIST NO. 2

All Tracts included in Vol Prescott NF Proc 6/10/21/1899

All Tracts included in Determination Area Pl. 167 3/18/1957
AR 017608

O Instr 248 1/29/1936 Vol NF 9 (AR-6) includes All Lands lying within 50' of center line of Trans. Line, Secs 30, 31, 32

Secs 30, 31 - Lot Acreage is not correct, due to inaccurate Mineral Surveys Resurveys pending.

MDS 225 NE

228 NW

227 SW

228 SE

229 SE

A 1460 PL 159 within Sec 36

AZA 23607 WD to US All including Road Esmt within MS 2734: M&B (Re: Pat No 242447)
MS 3154: M&B (Re: Pat No 593247)

AZA 300127 WD to US All including Road Esmt within MS 2728: M&B (Re: Pat No 165185)

Lat 34°27'22"N
Long 112°18'30"W

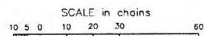

WARNING STATEMENT
This plot is the Bureau's Record of Title, and should be used only as a graphic display of the township survey data. Recorders herein do not reflect the changes which may have been effected by oral increments of title or other sources of water. Refer to the cadastral surveys for official survey information.

CURRENT TO	MM	T	13 N
2-2-2004	PM		
		R	1 W

